

DAVIS VINEYARD ESTATE PRECINCT 2 - STAGE 7

AUSTRALIAN INVESTMENT & DEVELOPMENTS PTY. LTD.

CITY OF MELTON

GENERAL NOTES

ALL WORKS ARE TO BE CARRIED OUT IN ACCORDANCE WITH THE CITY OF MELTON.

- STANDARD DRAWINGS & SPECIFICATIONS TO BE TO THE SATISFACTION OF THE MUNICIPAL ENGINEER OR HIS APPOINTED REPRESENTATIVE.
- THE LOCATION OF EXISTING SERVICES SHOULD BE DETERMINED BY THE CONTRACTOR PRIOR TO COMMENCING ANY EXCAVATION BY CONTACTING ALL LOCAL AUTHORITIES. ANY EXISTING SERVICES SHOWN ON THE DRAWINGS ARE OFFERED AS A GUIDE ONLY & ARE NOT GUARANTEED AS CORRECT.
- NO EXCAVATION SHALL BE CARRIED OUT WITH 5.00m OF ANY EXISTING TREE UNTIL APPROVAL HAS BEEN GIVEN BY THE SUPERINTENDENT.
- ALL NATURE STRIPS & EXCAVATED OR FILLED AREAS OUTSIDE OF THE ROAD RESERVES SHALL BE SURFACED WITH A 100mm LAYER OF TOPSOIL AS SPECIFIED.
- ALL ALLOTMENTS SHALL BE SMOOTHED, GRADED & SHAPED TO AN EVEN SURFACE WITH A MINIMUM FALL OF 1 IN 150 ALONG THE LOW BOUNDARY TO THE DRAINAGE OUTLET SHOWN.
- UNLESS OTHERWISE SPECIFIED OR DETAILED, ALL EASEMENT DRAINS ARE TO BE CONSTRUCTED TO AN OFFSET OF 0.90m FROM THE ALLOTMENT BOUNDARY.
- ALL KERB RETURN RADII ARE TO LIP OF KERB UNLESS OTHERWISE SPECIFIED.
- ALL PROPERTY INLETS TO BE CONSTRUCTED AT DEPTHS AND OFFSETS AS SPECIFIED IN EDCM STANDARD DRAWINGS 701, 702, 703 & 704.
- ALL HOUSE DRAIN CONNECTIONS ARE TO BE LOCATED NOT CLOSER THAN 5.20m FROM THE SIDE BOUNDARY OR FROM ANY EASEMENT ALONG THE SIDE BOUNDARY.
- THE CONTRACTOR SHALL TO THE SATISFACTION OF THE SUPERINTENDENT & THE MUNICIPAL ENGINEER PROVIDE AND MAINTAIN ALL NECESSARY WARNING SIGNAGE, LIGHTING & BARRICADING TO COMPLY WITH THE REQUIREMENTS OF THE ROAD TRAFFIC REGULATIONS ACT.
- ALL CONCRETE TO BE USED IN THE CONTRACT WORKS SHALL DEVELOP A MINIMUM COMPRESSIVE STRENGTH OF 25MPa AT 28 DAYS.
- THE CONTRACTOR TO ERECT STREET NAME SIGNS & GALVANISED IRON POSTS AS DIRECTED BY THE SUPERINTENDENT & PROVIDE THE PROVISION OF A SLEEVE.
- KERB TYPES TO BE USED AS SPECIFIED IN ACCORDANCE WITH MELTON CITY COUNCIL STANDARD DRAWINGS. TRANSITIONS BETWEEN DIFFERENT TYPES TO BE OVER 3.0m, IF IT CANNOT BE ACHIEVED AT A PRAM CROSSING OR DRIVEWAY CROSSOVER.
- THE CONTRACTOR WHEN ENGAGED IN BLASTING OPERATION, SHALL NOT BLAST WITH 4.50m OF AN EXISTING LINE OF WATER, GAS OR SEWER PIPES OR WITH 15m OF ANY COMPLETED PART OF THE WORKS WITHOUT THE CONSENT OF THE SUPERINTENDENT.
- THE CONTRACTOR IS TO OBTAIN THE NECESSARY ROAD OPENING PERMIT PRIOR TO UNDERTAKING ANY WORKS WITHIN A PREVIOUSLY CONSTRUCTED ROADWAY.
- ALL RESIDENTIAL FOOTPATHS TO BE OF A MINIMUM OF 1.50m WIDE.
- ALL TRENCHING OF DEPTH 1.5m OR GREATER MUST COMPLY WITH VICTORIAN WORKCOVER. A "Notice of Intention to Excavate" MUST BE SUBMITTED TO WORKCOVER BEFORE WORK COMMENCES. (FAXED TO 03 9628 8155 or 03 9628 8199)
- THE RELATIVE COMPACTION OF CRUSHED ROCK FOR PAVEMENTS SHALL BE COMPLETED AT THE OPTIMUM MOISTURE CONTENT TO A DRY DENSITY (BASED ON THE PERCENTAGE OF THE MAXIMUM DRY DENSITY OBTAINED IN THE MODIFIED COMPACTION TEST) AS BELOW:
 - FOR DEPTH 0 - 100mm BELOW TOP OF BASE. RELATIVE COMPACTION - 100%
 - FOR DEPTH 100 - 300mm BELOW TOP OF BASE. RELATIVE COMPACTION - 98%
 - FOR DEPTH OVER 300mm BELOW TOP OF BASE. RELATIVE COMPACTION - 97%
- PIPE TRENCHES WITHIN THE ROAD RESERVE MUST BE BACKFILLED WITH 20mm CLASS 3 CRUSHED ROCK TO BE COMPACTED TO A DRY DENSITY NOT LESS THAN 97% OF THE MAXIMUM FOUND IN THE STANDARD COMPACTION TEST FOR THE FOLLOWING:
 - BENEATH THE ROAD PAVEMENT OR DRIVEWAY CROSSOVER TO THE UNDERSIDE OF THE PAVEMENT OR CROSSOVER
 - ADJACENT TO KERBING OR CONCRETE WORKS TO A LEVEL THAT IS NOT AFFECTED BY A 45 DEGREE ANGLE OF REPOSE FROM THE NEAR LOWER EDGE.
- EARTH FILL IS TO BE COMPACTED TO A RELATIVE COMPACTION COMPARED TO A STANDARD COMPACTION TEST AS SPECIFIED BY VICROADS OF:
 - 100% FOR ALL FILL MATERIAL UNDER FILL THAT IS LESS THAN 450mm FROM THE SURFACE.
 - 95% FOR ALL FILL NOT COVERED AS ABOVE.
- THE SUBGRADE BELOW ALL PAVEMENTS SHALL BE COMPACTED TO A DRY DENSITY NOT LESS THAN 97% OF THE MAXIMUM FOUND IN STANDARD COMPACTION TEST IN AREAS OF CUT TO A DEPTH OF 150mm & IN AREAS OF FILL TO A DEPTH OF 450mm.
- TBM'S TO BE MAINTAINED & PROTECTED BY CONTRACTOR FOR THE DURATION OF THE WORKS.

- ALL DRAINAGE PIPES TO BE REINFORCED CONCRETE CLASS 2 UNLESS NOTED OTHERWISE.
- ALL DRAINAGE PIPES UP TO & INCLUDING 600 DIA ARE TO BE RUBBER RING JOINTED. ALL DRAINAGE PIPES LAID ON A CURVED ALIGNMENT ARE TO BE RUBBER RING JOINTED. ALL DRAINAGE PIPES LAID ACROSS A ROAD PAVEMENT ARE TO BE RUBBER RING JOINTED. DRAINAGE PIPES GREATER THAN 600 DIA WITHSTANDING THE ABOVE MAY BE FLUSH JOINTED INCORPORATING SAND BANDS.
- FILLING ON LOTS GREATER THAN 200mm (AS SHOWN BY APPROPRIATE HATCHING) TO BE PLACED BY THE CONTRACTOR UNDER LEVEL ONE (1) SUPERVISION IN ACCORDANCE WITH AS 3798 - 1996. ALL RESULTS TO BE FORWARDED TO THE SUPERINTENDENT FOR APPROVAL.
- ALL LEVELS SHOWN ARE TO A.H.D.
- TACTILE GROUND SURFACE INDICATORS (TGS) ARE TO BE INSTALLED AT ALL PRAM CROSSINGS & PEDESTRIAN CROSS POINTS IN ACCORDANCE WITH AS 1428.
- CONTRACTOR IS OBLIGED TO OBTAIN A PERMIT FOR ANY BLASTING WORKS.
- ALL TRENCHING AT A DEPTH 1.5m OR GREATER MUST COMPLY WITH THE MINES AND TRENCHING REGULATIONS.
- WORKS ARE TO BE CARRIED OUT TO EDCM STANDARDS.
- ALL CUT AND FILL BATTERS SHOWN ON THE PLANS TO BE GRADED AT 1 IN 6 TO EXISTING SURFACE.

DRAWING INDEX

DRAWING No.	TITLE
1600059-07-001	COVER SHEET
1600059-07-002	TYPICAL ROAD CROSS SECTIONS, AND GENERAL DETAILS
1600059-07-003	PAVEMENT MAKEUP
1600059-07-010	LAYOUT PLAN
1600059-07-012	INTEGRATED WATER MANAGEMENT PLAN (SHEET 1 OF 2)
1600059-07-013	INTEGRATED WATER MANAGEMENT PLAN (SHEET 2 OF 2)
1600059-07-100	ROAD LONGITUDINAL SECTIONS AVIATION DRIVE & BUD STREET
1600059-07-101	ROAD LONGITUDINAL SECTIONS MADISONS AVENUE & VIOLETTA BOULEVARD
1600059-07-200	ROAD CROSS SECTIONS AVIATION DRIVE
1600059-07-201	ROAD CROSS SECTIONS BUD STREET
1600059-07-202	ROAD CROSS SECTIONS MADISONS AVENUE
1600059-07-203	ROAD CROSS SECTIONS VIOLETTA BOULEVARD
1600059-07-300	INTERSECTION DETAILS (SHEET 1 OF 2)
1600059-07-301	INTERSECTION DETAILS (SHEET 2 OF 2)
1600059-07-350	SIGNAGE & LINE MARKING PLANS
1600059-07-400	DRAINAGE LONGITUDINAL SECTIONS (SHEET 1 OF 2)
1600059-07-401	DRAINAGE LONGITUDINAL SECTIONS (SHEET 2 OF 2) AND PIT SCHEDULE

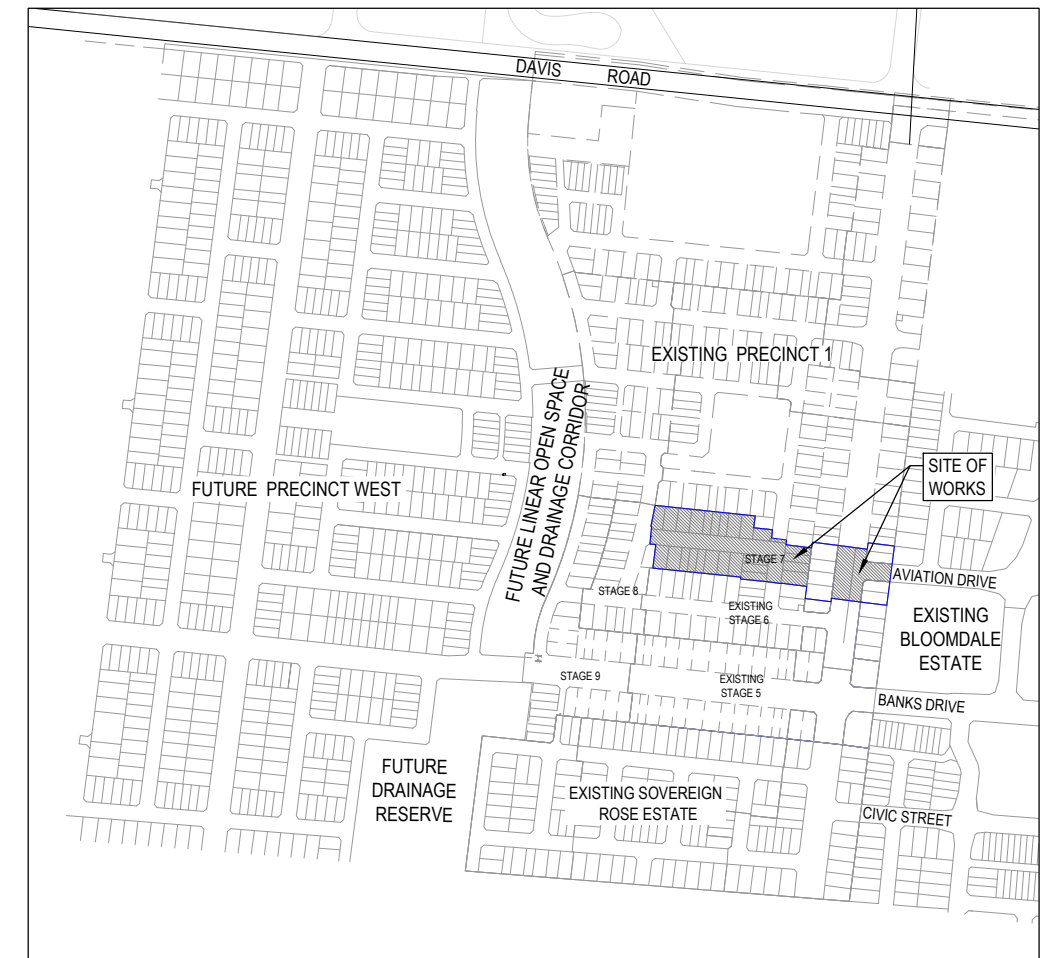

SITE PLAN
NOT TO SCALE
MELWAY REF: 351 H2

ISSUED FOR CONSTRUCTION

REV	DESCRIPTION	DATE	DRN.	APP.	REV	DESCRIPTION	DATE	DRN.	APP.
B	DRAWING INDEX UPDATED	28.03.22	DZ	SM					
A	ISSUED FOR CONSTRUCTION	07.12.21	NT	RW					
P2	ISSUED FOR REVIEW	12.10.21	LS	RW					
P1	ISSUED FOR TENDER	01.09.21	LS	RW					

© COPYRIGHT All rights reserved Beveridge Williams & Co. Pty Ltd has granted a licence to the principle to use this document for its intended purpose. No unauthorised copying is permitted									
---	--	--	--	--	--	--	--	--	--

Designed Date	S. GILBERT 23.08.21
Drawn	L. SUTHERLAND
Approved Date	R. WICKETT 7.10.2021
PS Number	PS 822978N/S3



Project Details	DAVIS VINEYARD - STAGE 7 AUST. INVESTMENT & DEVELOPMENT P/L CITY OF MELTON
Drawing Title	COVER SHEET

Sheet 01 of 17			
NOT TO SCALE			
Project Ref	Stage No	Drawing No	Rev
1600059	07	001	B

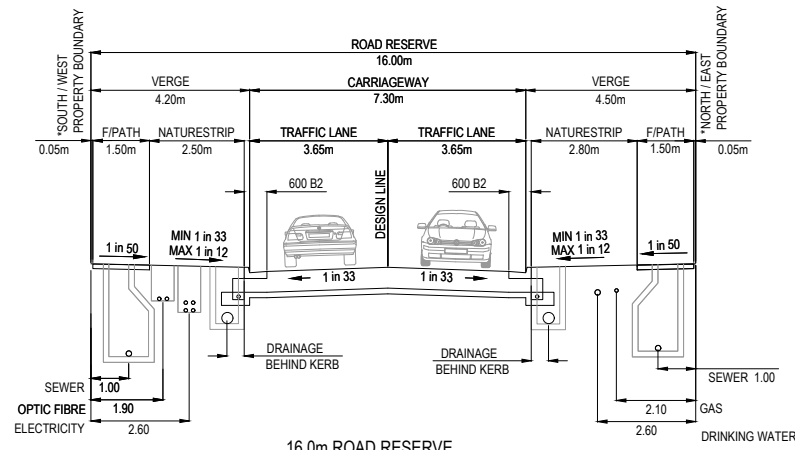

16.0m ROAD RESERVE
VIOLETTA BOULEVARD & *BUD STREET
N.T.S.

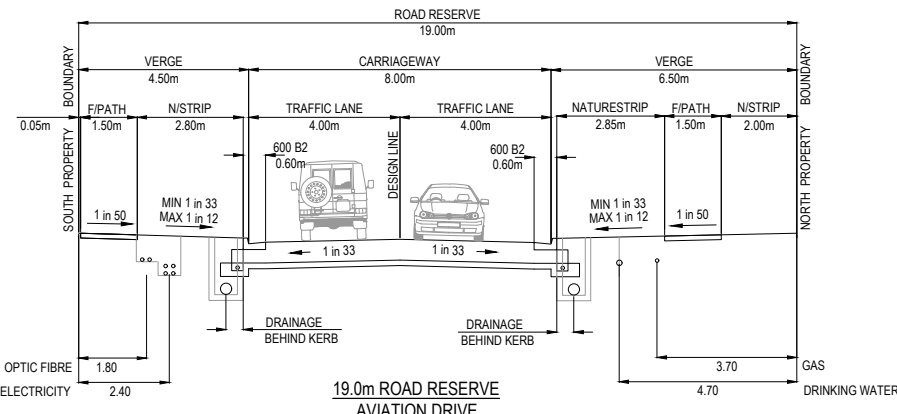

19.0m ROAD RESERVE
AVIATION DRIVE
N.T.S.
NOTE: MATCH EXISTING BLOOMDALE ESTATE

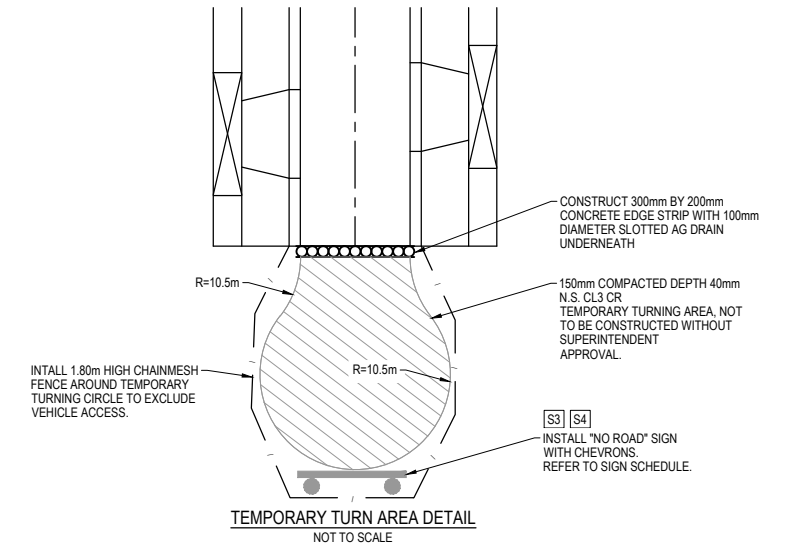

TEMPORARY TURN AREA DETAIL
NOT TO SCALE

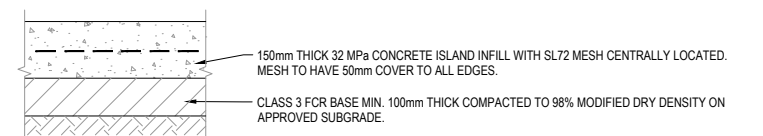

PAVEMENT COMPOSITION FOR SPLITTER ISLAND CONCRETE INFILL
250mm DEPTH
N.T.S.

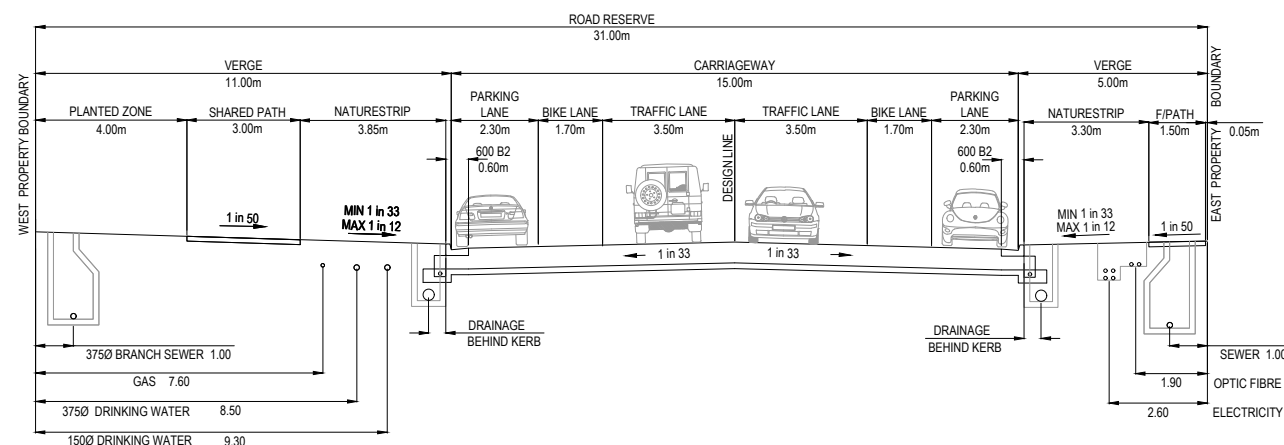

31.0m ROAD RESERVE
MADISONS AVENUE
N.T.S.

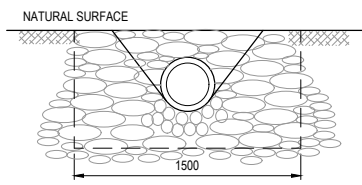

END ELEVATION

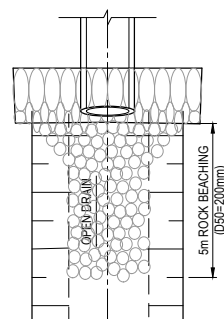

PLAN

SANDBAG ENDWALL DETAIL
NOT TO SCALE

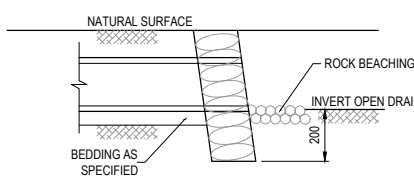

SIDE ELEVATION

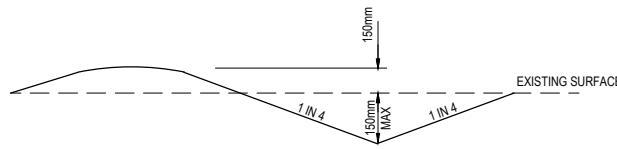

SWALE DRAIN DETAIL
NOT TO SCALE

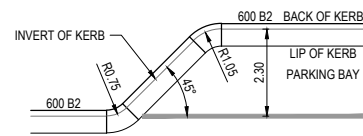

TYPICAL KERB OUTSTAND SETOUT DETAIL
NOT TO SCALE

ISSUED FOR CONSTRUCTION

REV	DESCRIPTION	DATE	DRN.	APP.	REV	DESCRIPTION	DATE	DRN.	APP.
B	DRAWING INDEX UPDATED	28.03.22	DZ	SM					
A	ISSUED FOR CONSTRUCTION	07.12.21	NT	RW					
P2	ISSUED FOR REVIEW	12.10.21	LS	RW					
P1	ISSUED FOR TENDER	01.09.21	LS	RW					

Designed S. GILBERT
Date 23.08.21
Drawn L. SUTHERLAND
Approved R. WICKETT
Date 7.10.2021
PS Number PS 822978N/S3



Project Details
DAVIS VINEYARD - STAGE 7
AUST. INVESTMENT & DEVELOPMENT P/L
CITY OF MELTON
Drawing Title
TYPICAL ROAD CROSS SECTIONS,
AND GENERAL DETAILS

Sheet 02 of 17	
Scale NOT TO SCALE	
Project Ref 1600059	Stage No 07
Drawing No 002	Rev B

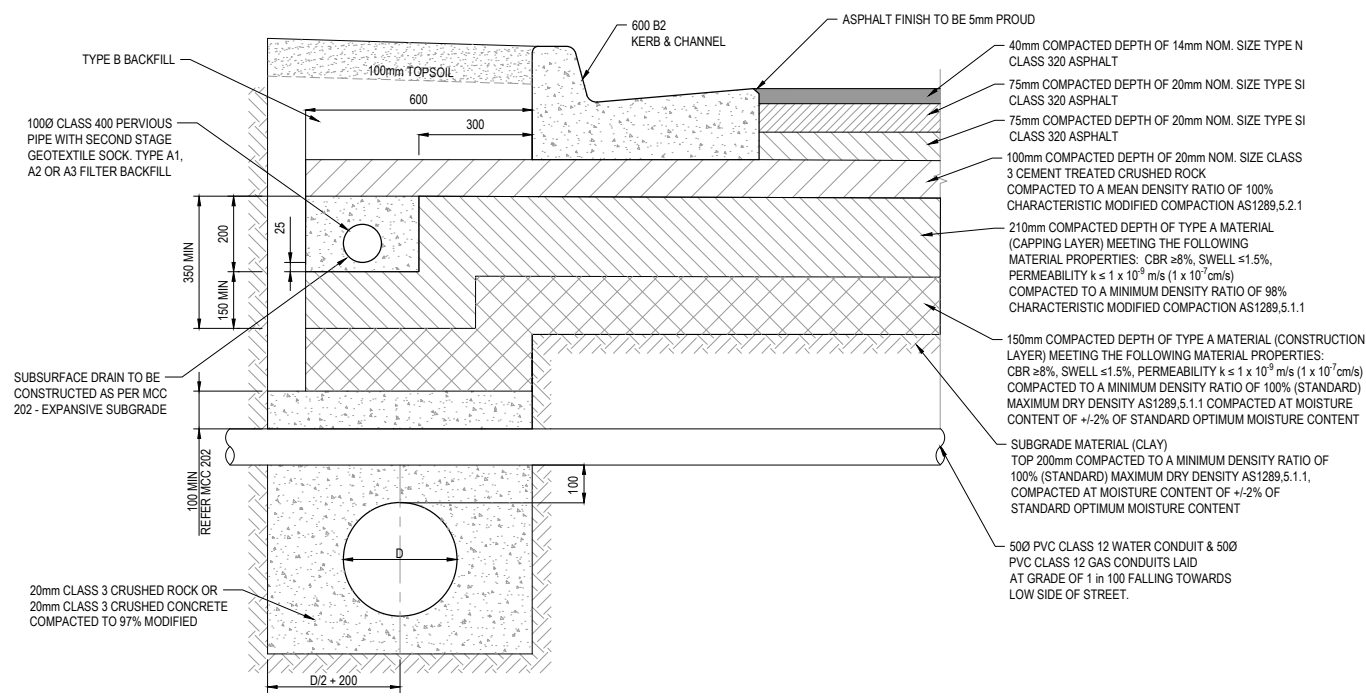

PAVEMENT COMPOSITION FOR MADISONS AVENUE
65mm DEPTH
N.T.S.

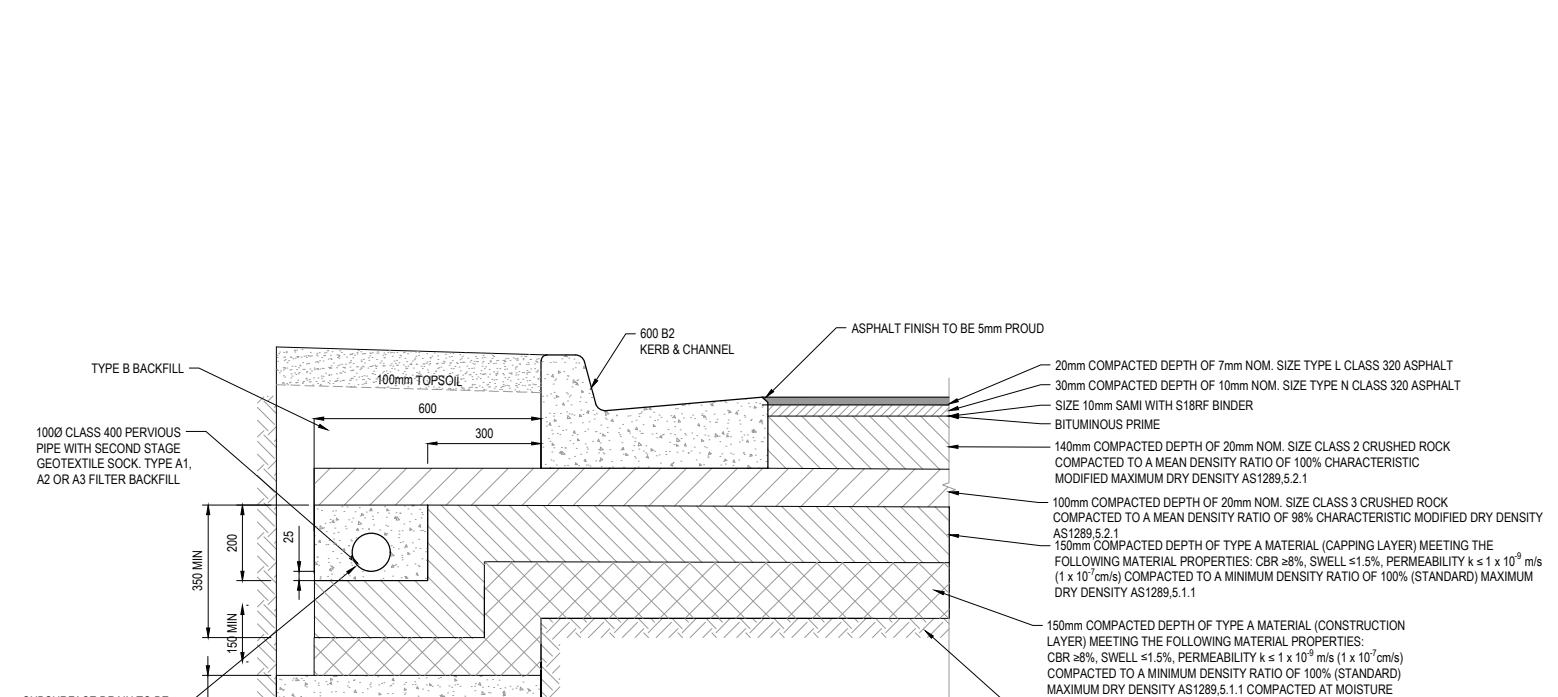

PAVEMENT COMPOSITION FOR BUD STREET
600mm DEPTH
N.T.S.

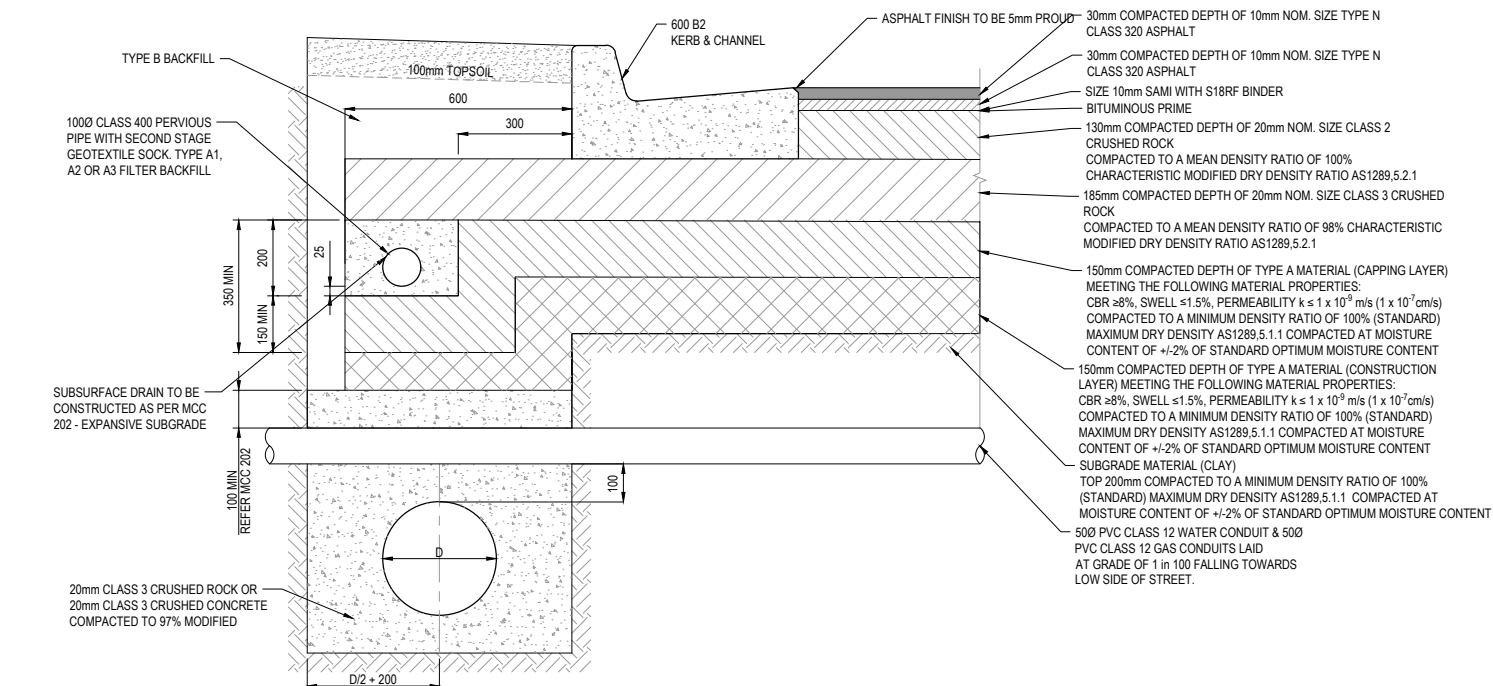

**PAVEMENT COMPOSITION FOR VIOLETTA BOULEVARD,
& AVIATION DRIVE**
675mm DEPTH
N.T.S.

ISSUED FOR CONSTRUCTION

© COPYRIGHT All rights reserved Beveridge Williams & Co. Pty Ltd has granted a licence to the principle to use this document for its intended purpose. No unauthorised copying is permitted.				
C	DRAWING INDEX UPDATED	28.03.22	DZ	SM
B	AG DETAIL UPDATED	25.02.22	NT	RW
A	ISSUED FOR CONSTRUCTION	07.12.21	NT	RW
P2	ISSUED FOR REVIEW	12.10.21	LS	RW
P1	ISSUED FOR TENDER	01.09.21	LS	RW
REV	DESCRIPTION	DATE	DRN.	APP.

DESCRIPTION	DATE	DRN.	APP.	REV	DESCRIPTION	DATE	DRN.	APP.
PAVEMENT COMPACTION UPDATED	6.04.22	SG	SM					

Designed S. GILBERT
Date 23.08.21
Drawn L. SUTHERLAND
Approved R. WICKETT
Date 7.10.2021
PS Number PS 822978/N/3

BW Beveridge Williams
1 Glenferrie Road
Malvern VIC 3144
ph: 03 9524 8888
www.beveridgewilliams.com.au

Project Details
DAVIS VINEYARD - STAGE 7
AUST. INVESTMENT & DEVELOPMENT P/L
CITY OF MELTON
Drawing Title
PAVEMENT MAKEUP

Sheet 03 of 17	Scale NOT TO SCALE
Project Ref 1600059	Stage No 07
Drawing No 003	Rev D

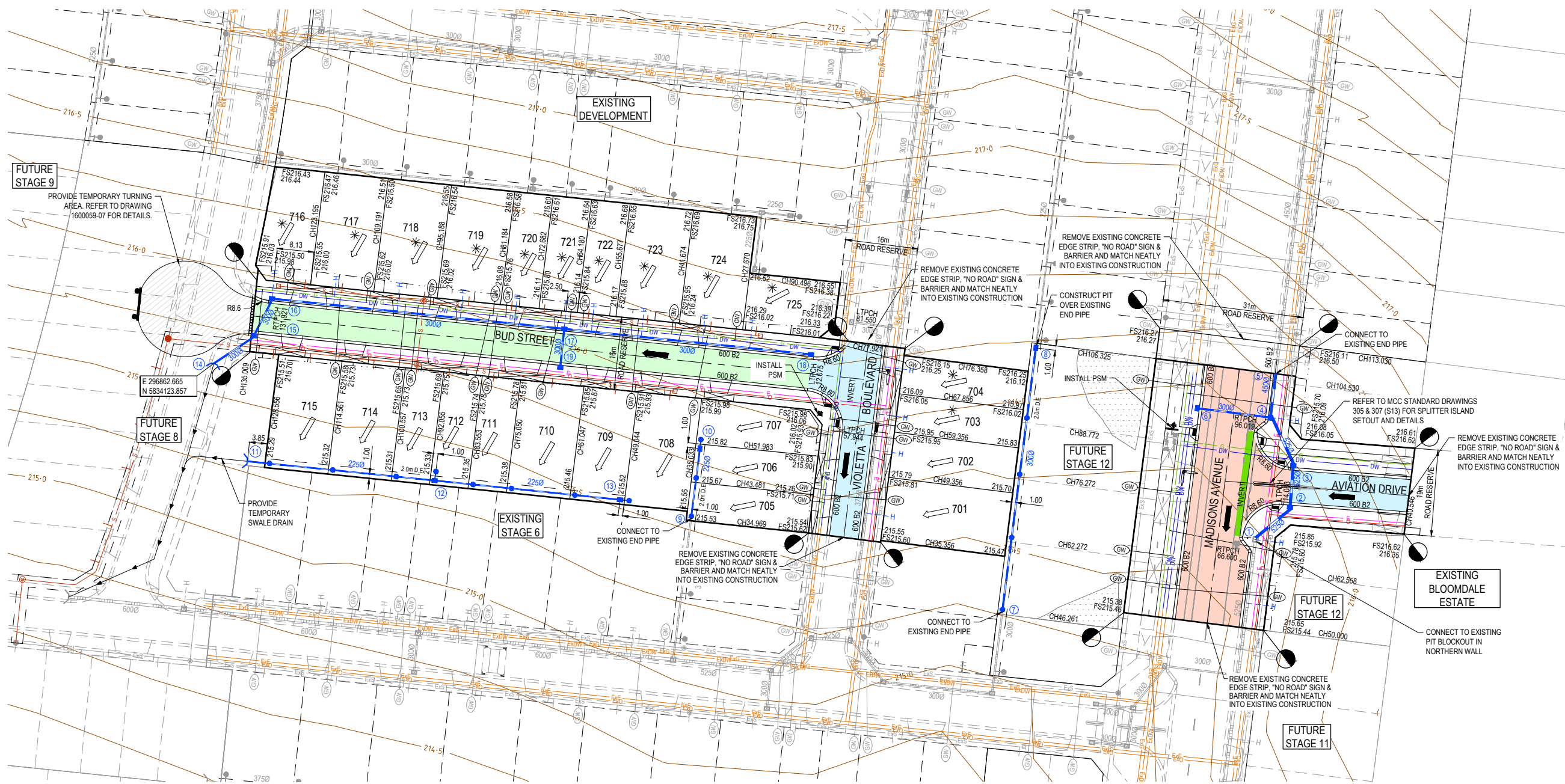

LEGEND - LAYOUT PLAN

STORMWATER DRAIN, PIT & PROPERTY INLET	EXISTING STORMWATER DRAIN	EXISTING SURFACE LEVEL	DIRECTION OF FALL
MELBOURNE WATER DRAIN & PIT	EXISTING ELECTRICITY (UNDERGROUND)	FINISHED BUILDING LINE LEVEL	OVERLAND FLOW
SWALE DRAIN	EXISTING ELECTRICITY (OVERHEAD)	FINISHED RIDGE LINE LEVEL	ALLOTMENT TO BE GRADED EVENLY IN
SEWER & MAINTENANCE STRUCTURES	EXISTING GAS	TOP OF RETAINING WALL	DIRECTION OF FALL TO LEVELS INDICATED
HOUSE DRAIN	EXISTING OPTIC FIBRE	BOTTOM OF RETAINING WALL	CONCRETE EDGE STRIP WITH SUBSOIL DRAIN, "NO ROAD" SIGN & BARRIER
SERVICE CONDUITS	EXISTING TELECOMMUNICATIONS	RIDGE LINE	LIMIT OF WORKS
ELECTRICITY (UNDERGROUND)	EXISTING WATER	RETAINING WALL	EXISTING TREE TO BE REMOVED
ELECTRICITY (OVERHEAD)	EXISTING RECYCLED WATER	ZERO LOT LINES	PERMANENT SURVEY MARK
OPTIC FIBRE	EXISTING SEWER	PAVEMENT TREATMENT	TEMPORARY BENCH MARK
TELECOMMUNICATIONS	EXISTING HOUSE DRAIN	STRUCTURAL FILL > 200mm DEEP	PROPOSED DRIVEWAY
GAS	EXISTING SWALE DRAIN	EX. STRUCTURAL FILL > 200mm DEEP	
WATER	TACTILE PAVERS (INDICATIVE ONLY)		
RECYCLED WATER			

SERVICE OFFSET TABLE

Location	Side	Gas		Water		Electricity		Telecommunication		Sewer	
		Side	Offset (m)	Side	Offset (m)	Side	Offset (m)	Side	Offset (m)	Side	Offset (m)
MADISONS AVENUE	W	W	7.70	W	9.30 (1500)	E	2.60	E	1.90	EW	1.00
		W		W	8.50 (3750)						
AVIATION DRIVE	N		3.70	N	4.70	S	2.40	S	1.80	-	-
VIOLETTA BOULEVARD	E		2.10	E	2.60	W	2.60	W	1.90	EW	1.00
BUD STREET	N		2.10	N	2.60	S	2.60	S	1.90	NS	1.00

NOTE: STREET TREES ARE TO BE PLANTED IN THE CENTRE OF ALL NATURE STRIPS

NOTE:
 REFER COUNCIL STD. DWG.
 MCC 305 & 307 FOR ISLAND DETAIL - S13
 MCC 308 FOR ISLAND DETAIL - S13 ON 90° BENDS
 MCC 501 FOR SINGLE VEHICLE CROSSING
 MCC 503 FOR DOUBLE VEHICLE CROSSING
 MCC 504 FOR INDUSTRIAL VEHICLE CROSSING

PAVEMENT AREAS

- 650mm DEEP PAVEMENT
- 675mm DEEP PAVEMENT
- 600mm DEEP PAVEMENT

WARNING
BWARE OF UNDERGROUND SERVICES
 The locations of underground services are approximate only and their exact position should be proven on site.
 No guarantee is given that all existing services are shown. Locate all underground services before commencement of works.
DIAL 1100 BEFORE YOU DIG
 www.1100.com.au

ISSUED FOR CONSTRUCTION

© COPYRIGHT All rights reserved
 Beveridge Williams & Co. Pty Ltd has granted a licence to the principle to use this document for its intended purpose.
 No unauthorised copying is permitted.

REV	DESCRIPTION	DATE	DRN.	APP.	REV	DESCRIPTION	DATE	DRN.	APP.
C	DRAWING INDEX UPDATED	28.03.22	DZ	SM					
B	VIOLETTA PRAM CROSSING ADDED	25.02.22	NT	RW					
A	ISSUED FOR CONSTRUCTION	07.12.21	NT	RW					
P2	ISSUED FOR REVIEW	12.10.21	LS	RW					
P1	ISSUED FOR TENDER	01.09.21	LS	RW					

REV	DESCRIPTION	DATE	DRN.	APP.	REV	DESCRIPTION	DATE	DRN.	APP.



Designed: S. GILBERT
 Date: 23.08.21
 Drawn: L. SUTHERLAND
 Approved: R. WICKETT
 Date: 7.10.2021
 PS Number: PS 822978N/S3

BW Beveridge Williams
 1 Glenferrie Road
 Malvern VIC 3144
 ph: 03 9524 8888
 www.beveridgewilliams.com.au

Project Details: DAVIS VINEYARD - STAGE 7
 AUST. INVESTMENT & DEVELOPMENT P/L
 CITY OF MELTON
 Drawing Title: LAYOUT PLAN

Sheet 04 of 17
 Scale: 1:500 @ A1
 Project Ref: 1600059
 Stage No: 07
 Drawing No: 010
 Rev: D

K:\Jobs Data\1600059 Diggers Rest_Eng\Precinct 2\Stage 7\Drawings\1600059-07-010-LAY.dwg

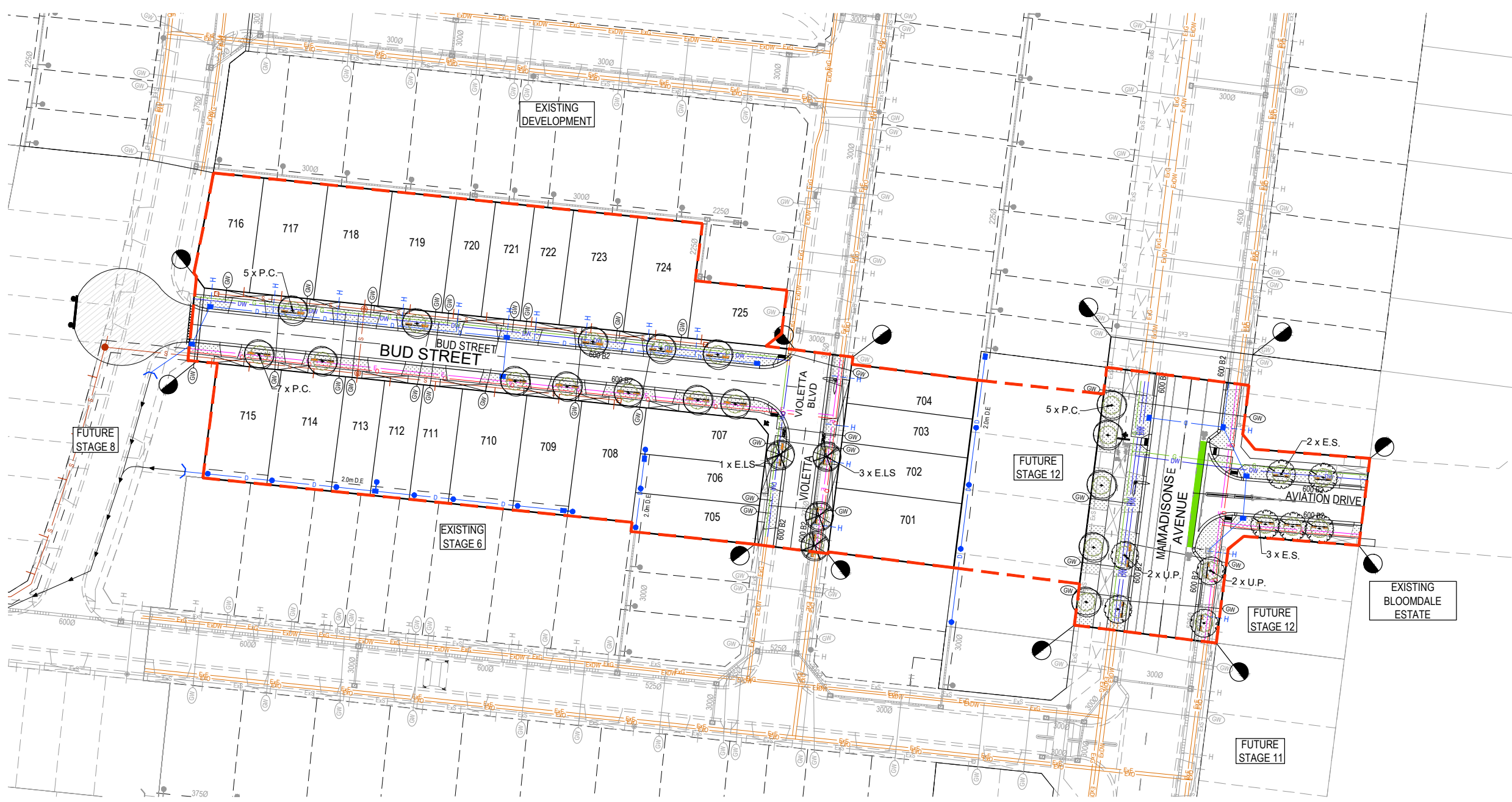

LEGEND - LAYOUT PLAN

- D — STORMWATER DRAIN, PIT & PROPERTY INLET
- S — SEWER & MAINTENANCE STRUCTURES
- H — HOUSE DRAIN
- GW — SERVICE CONDUITS
- TP — TACTILE PAVERS (INDICATIVE ONLY)
- E — ELECTRICITY (UNDERGROUND)
- OH E — ELECTRICITY (OVERHEAD)
- O — OPTIC FIBRE
- T — TELECOMMUNICATIONS
- G — GAS
- DW — WATER
- NDW — RECYCLED WATER
- ExE — EXISTING ELECTRICITY (UNDERGROUND)
- ExOH E — EXISTING ELECTRICITY (OVERHEAD)
- ExG — EXISTING GAS
- ExO — EXISTING OPTIC FIBRE
- ExT — EXISTING TELECOMMUNICATIONS
- ExDW — EXISTING WATER
- ExNDW — EXISTING RECYCLED WATER
- Ex D — EXISTING STORMWATER DRAIN
- Ex S — EXISTING SEWER
- Ex H — EXISTING HOUSE DRAIN
- Ex SW — EXISTING SWALE DRAIN
- RL — RIDGE LINE
- RW — RETAINING WALL
- ZL — ZERO LOT LINES
- DF — DIRECTION OF FALL
- * — ALLOTMENT TO BE GRADED EVENLY IN DIRECTION OF FALL TO LEVELS INDICATED
- CES — CONCRETE EDGE STRIP WITH SUBSOIL DRAIN, "NO ROAD" SIGN & BARRIER
- LW — LIMIT OF WORKS
- PSM — PERMANENT SURVEY MARK
- TBM — TEMPORARY BENCH MARK
- PD — PROPOSED DRIVEWAY
- PSTR — PASSIVE STREET TREE IRRIGATION
- GT — GRAVEL TRENCH
- PT — PROPOSED TREE

NOTE:
TREE LOCATIONS SHOWN ARE PRELIMINARY AND FINAL TREE LOCATION SUBJECT TO ELECTRICAL AND STREETSCAPE DESIGNS

WARNING
BWARE OF UNDERGROUND SERVICES
The locations of underground services are approximate only and their exact position should be proven on site.
No guarantee is given that all existing services are shown.
Locate all underground services before commencement of works
DIAL 1100 BEFORE YOU DIG
www.1100.com.au

ISSUED FOR CONSTRUCTION

REV	DESCRIPTION	DATE	DRN.	APP.	REV	DESCRIPTION	DATE	DRN.	APP.
C	PLAN UPDATED AS PER AMENDED LANDSCAPE PLANS	28.03.22	DZ	SM					
B	VIOLETTA PRAM CROSSING ADDED	25.02.22	NT	RW					
A	ISSUED FOR CONSTRUCTION	07.12.21	NT	RW					
P2	ISSUED FOR REVIEW	12.10.21	LS	RW					
P1	ISSUED FOR TENDER	01.09.21	LS	RW					

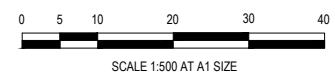

Designed: S. GILBERT
Date: 23.08.21
Drawn: L. SUTHERLAND
Approved: R. WICKETT
Date: 7.10.2021
PS Number: PS 822978N/S3

BW Beveridge Williams
1 Glenferrie Road
Malvern VIC 3144
ph: 03 9524 8888
www.beveridgewilliams.com.au

Project Details: DAVIS VINEYARD - STAGE 7
AUST. INVESTMENT & DEVELOPMENT P/L
CITY OF MELTON
Drawing Title: INTEGRATED WATER MANAGEMENT PLAN
(SHEET 1 OF 2)

Sheet 05 of 17
Scale: 1:500 @ A1
Project Ref: 1600059
Stage No: 07
Drawing No: 012
Rev: C

K:\Jobs Data\1600059 Diggers Rest_Eng\Preinct 2\Stage 7\Drawings\1600059-07-012.LAY.dwg

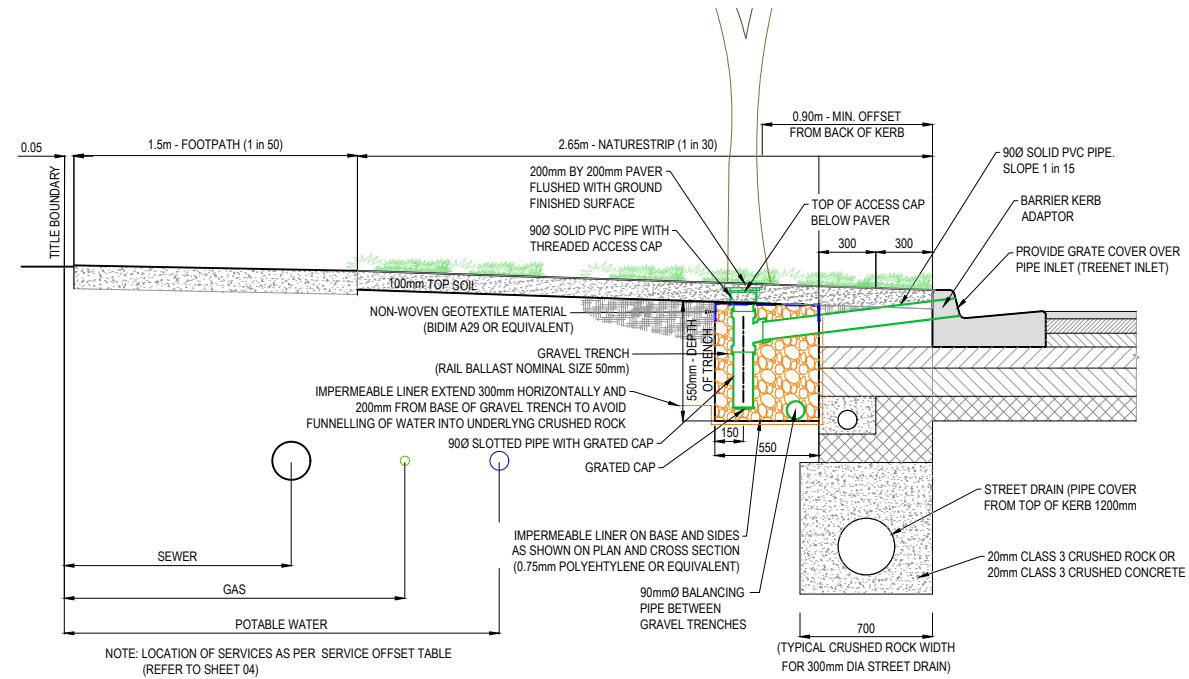

PASSIVE STREET TREE IRRIGATION GRAVEL TRENCH
(KERB INLET DIVERSION)
CROSS SECTION A-A
N.T.S.

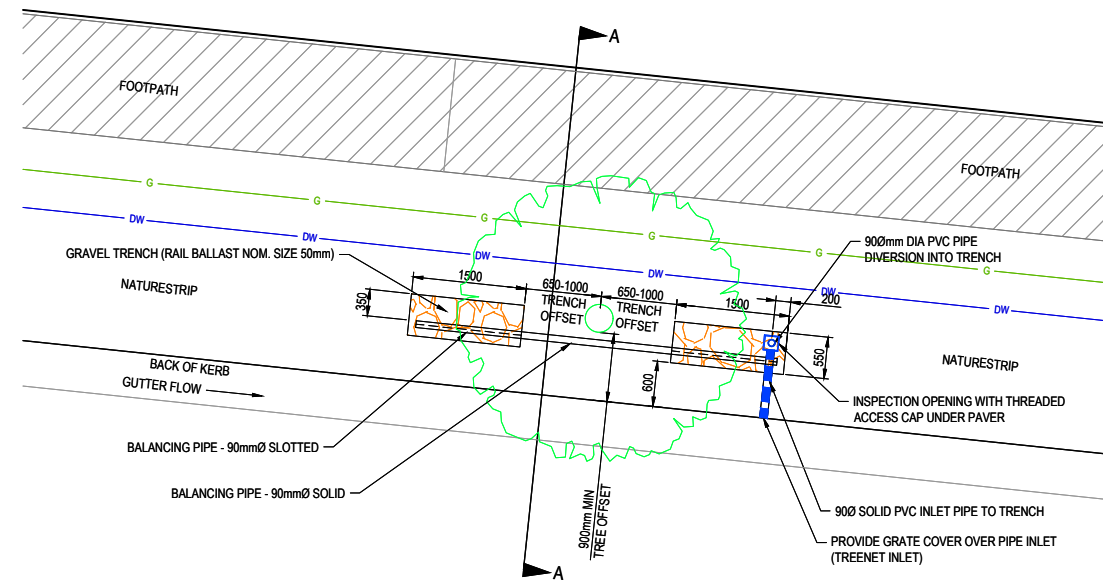

PASSIVE STREET TREE IRRIGATION GRAVEL TRENCH
(KERB INLET DIVERSION)
PLAN
N.T.S.

- NOTES:
- AT HIGHLY CONSTRAINED SITES, GRAVEL TRENCHES CAN BE MODIFIED IN THE FOLLOWING WAYS:
 - REDUCED OFFSET OF 0.75m FROM TREE CENTRELINE
 - DIMENSION 1.0m LONG x 0.6m WIDE x 0.75m DEEP
 - NATURESTRIP \leq 2.5m DIMENSION CAN BE 1.5m LONG x 0.4m WIDE x 0.75m DEEP
 - PASSIVE IRRIGATION PLANS TO BE READ IN CONJUNCTION WITH LANDSCAPE PLANS.

ISSUED FOR CONSTRUCTION

REV	DESCRIPTION	DATE	DRN.	APP.	REV	DESCRIPTION	DATE	DRN.	APP.
A	ISSUED FOR CONSTRUCTION	07.12.21	NT	RW					
P2	ISSUED FOR REVIEW	12.10.21	LS	RW					
P1	ISSUED FOR TENDER	01.09.21	LS	RW					

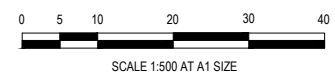

Designed S. GILBERT
Date 23.08.21
Drawn L. SUTHERLAND
Approved R. WICKETT
Date 7.10.2021
PS Number PS 822978N/S3



Project Details
DAVIS VINEYARD - STAGE 7
AUST. INVESTMENT & DEVELOPMENT P/L
CITY OF MELTON
Drawing Title
INTEGRATED WATER MANAGEMENT PLAN
(SHEET 2 OF 2)

Sheet 06 of 17
Scale 1:500 @ A1
Project Ref 1600059
Stage No 07
Drawing No 013
Rev A

LEGEND	
	EXISTING SURFACE
	DESIGN LINE
	FUTURE DESIGN LINE
	EXISTING SURFACE AT RIGHT BOUNDARY
	RIGHT LIP OF KERB
	EXISTING SURFACE AT LEFT BOUNDARY
	LEFT LIP OF KERB

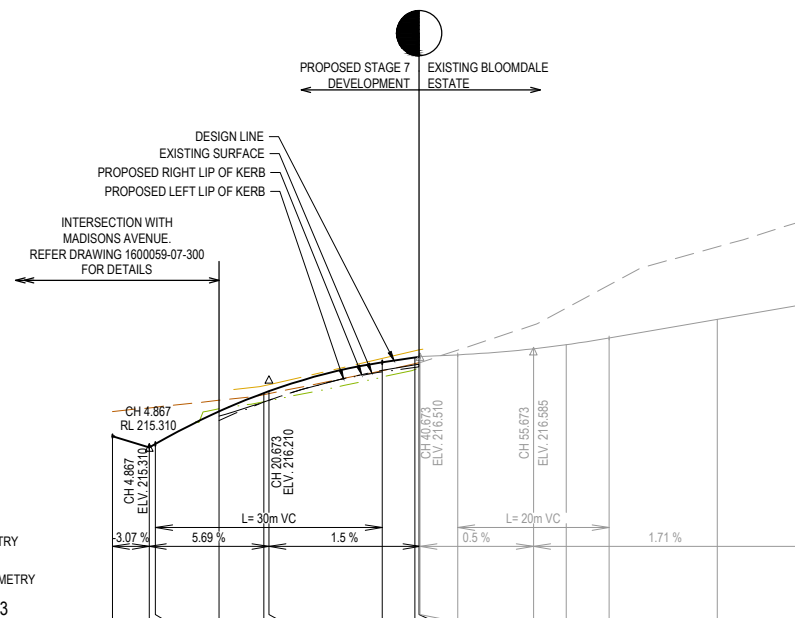

	0.000	4.867	5.673	14.063	20.000	20.673	35.673	40.000	40.673	45.673	55.673	60.000	65.673	80.000	90.546	217.183
DESIGN CENTRELINE	215.460	215.310	215.356	215.784	215.823	215.666	216.241	216.435	216.505	216.535	216.615	216.689	216.756	217.002	217.183	
RIGHT LIP OF KERB				215.724	215.823	215.666	216.241	216.308	216.367	216.389	216.401	216.389	216.357	216.308	216.241	
EXISTING SURFACE AT RIGHT BOUNDARY				215.909	215.915	215.928	216.341	216.401	216.389	216.357	216.308	216.241	216.174	216.107	216.040	
LEFT LIP OF KERB				215.909	215.915	215.928	216.341	216.401	216.389	216.357	216.308	216.241	216.174	216.107	216.040	
EXISTING SURFACE AT LEFT BOUNDARY				216.009	216.125	216.138	216.487	216.587	216.600	216.600	216.597	216.526	216.457	216.389	216.322	
EXISTING SURFACE	215.786	215.833	215.842	215.933	216.022	216.138	216.325	216.418	216.430	216.430	216.526	216.597	216.666	216.735	217.363	218.283
CHAINAGE	0.000	4.867	5.673	14.063	20.000	20.673	35.673	40.000	40.673	45.673	55.673	60.000	65.673	80.000	90.546	217.183

AVIATION DRIVE LONGITUDINAL SECTION

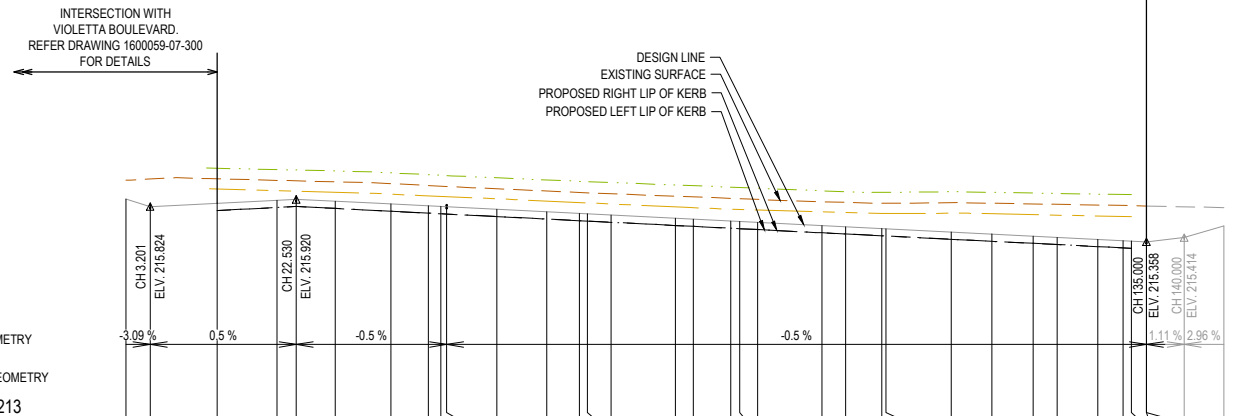

	0.000	3.201	12.075	20.000	22.530	27.670	35.033	40.000	41.674	42.408	49.044	55.677	60.000	61.047	64.180	72.882	75.050	80.000	81.184	83.553	92.055	95.188	100.000	100.357	109.191	114.661	120.000	123.195	128.556	131.821	132.000	135.009	140.000	145.238	215.810	
DESIGN CENTRELINE	215.923	215.824	215.888	215.812	215.824	215.799	215.762	215.737	215.729	215.725	215.788	215.755	215.733	215.728	215.712	215.670	215.659	215.633	215.627	215.619	215.573	215.557	215.533	215.536	215.487	215.460	215.433	215.417	215.390	215.374	215.374	215.368	215.358	215.414	215.569	
RIGHT LIP OF KERB			215.772	215.812	215.824	215.799	215.762	215.737	215.729	215.725	215.692	215.659	215.637	215.632	215.616	215.574	215.562	215.537	215.531	215.519	215.477	215.461	215.437	215.434	215.381	215.354	215.337	215.321	215.294	215.278	215.278	215.272	215.321	215.474	215.629	
EXISTING SURFACE AT RIGHT BOUNDARY			215.772	215.812	215.824	215.799	215.762	215.737	215.729	215.725	215.692	215.659	215.637	215.632	215.616	215.574	215.562	215.537	215.531	215.519	215.477	215.461	215.437	215.434	215.381	215.354	215.337	215.321	215.294	215.278	215.278	215.272	215.321	215.474	215.629	
LEFT LIP OF KERB			215.772	215.812	215.824	215.799	215.762	215.737	215.729	215.725	215.692	215.659	215.637	215.632	215.616	215.574	215.562	215.537	215.531	215.519	215.477	215.461	215.437	215.434	215.381	215.354	215.337	215.321	215.294	215.278	215.278	215.272	215.321	215.474	215.629	
EXISTING SURFACE AT LEFT BOUNDARY			215.772	215.812	215.824	215.799	215.762	215.737	215.729	215.725	215.692	215.659	215.637	215.632	215.616	215.574	215.562	215.537	215.531	215.519	215.477	215.461	215.437	215.434	215.381	215.354	215.337	215.321	215.294	215.278	215.278	215.272	215.321	215.474	215.629	
EXISTING SURFACE	216.172	216.188	216.191	216.034	216.026	216.013	215.989	215.965	215.958	215.955	215.927	215.897	215.877	215.872	215.858	215.819	215.809	215.790	215.786	215.779	215.735	215.716	215.732	215.732	215.689	215.654	215.635	215.618	215.602	215.586	215.586	215.580	215.572	215.621	215.776	
CHAINAGE	0.000	3.201	12.075	20.000	22.530	27.670	35.033	40.000	41.674	42.408	49.044	55.677	60.000	61.047	64.180	72.882	75.050	80.000	81.184	83.553	92.055	95.188	100.000	100.357	109.191	114.661	120.000	123.195	128.556	131.821	132.000	135.009	140.000	145.238	215.810	

BUD STREET LONGITUDINAL SECTION

ISSUED FOR CONSTRUCTION

REV	DESCRIPTION	DATE	DRN.	APP.	REV	DESCRIPTION	DATE	DRN.	APP.
B	DRAWING INDEX UPDATED	28.03.22	DZ	SM					
A	ISSUED FOR CONSTRUCTION	07.12.21	NT	RW					
P2	ISSUED FOR REVIEW	12.10.21	LS	RW					
P1	ISSUED FOR TENDER	01.09.21	LS	RW					

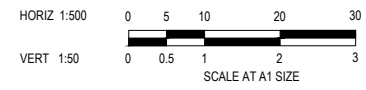

Designed: S. GILBERT
Date: 23.08.21
Drawn: L. SUTHERLAND
Approved: R. WICKETT
Date: 7.10.2021
PS Number: PS 822978N/S3

BW Beveridge Williams
1 Glenferrie Road
Malvern VIC 3144
ph: 03 9524 8888
www.beveridgewilliams.com.au

Project Details: DAVIS VINEYARD - STAGE 7
AUST. INVESTMENT & DEVELOPMENT P/L
CITY OF MELTON

Sheet 07 of 17
Scale: 1:500 H 1:50 V @ A1

Drawing Title: ROAD LONGITUDINAL SECTIONS
AVIATION DRIVE & BUD STREET

Project Ref	Stage No	Drawing No	Rev
1600059	07	100	B

K:\Jobs Data\1600059 Diggers Rest_Eng\Precond\2\Stage 7\Drawings\1600059-07-100-RLS.dwg

LEGEND	
	EXISTING SURFACE
	DESIGN LINE
	FUTURE DESIGN LINE
	EXISTING SURFACE AT RIGHT BOUNDARY
	RIGHT LIP OF KERB
	EXISTING SURFACE AT LEFT BOUNDARY
	LEFT LIP OF KERB

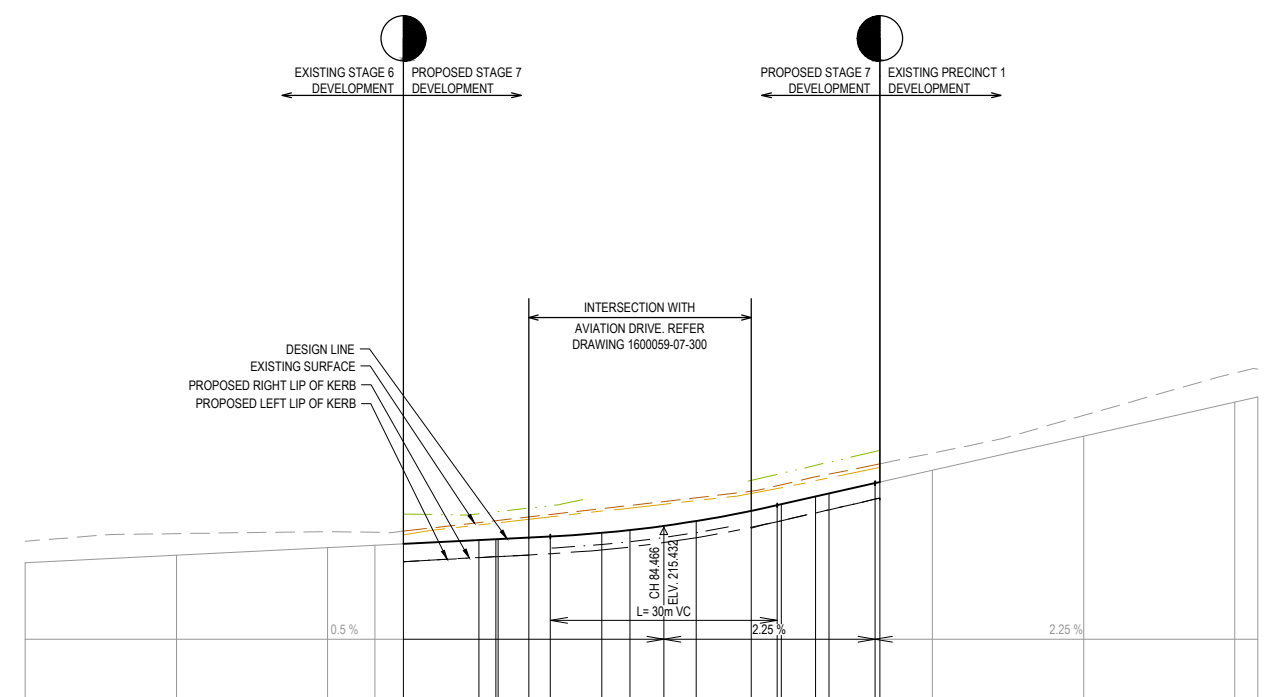

CHAINAGE	DESIGN CENTRELINE	RIGHT LIP OF KERB	EXISTING SURFACE AT RIGHT BOUNDARY	LEFT LIP OF KERB	EXISTING SURFACE AT LEFT BOUNDARY	EXISTING SURFACE
0.00	215.010					215.296
20.00	215.110					215.396
40.00	215.210					215.423
46.261	215.241					215.413
50.000	215.260	215.025	215.654	215.025	215.380	215.428
60.000	215.310	215.079	215.668	215.079	215.511	215.542
62.556	215.321	215.083	215.673	215.083	215.540	215.571
66.000	215.343	215.114	215.733	215.114	215.585	215.617
69.466	215.357	215.130	215.765	215.130	215.595	215.649
76.272	215.405	215.251	215.805	215.251	215.693	215.727
80.000	215.443	215.289	215.843	215.289	215.734	215.734
84.466	215.498	215.345	215.898	215.345	215.784	215.784
88.772	215.563	215.409	215.963	215.409	215.832	215.832
96.019	215.686	215.467	216.099	215.467	215.927	215.927
99.466	215.770	215.554	216.180	215.554	215.990	216.028
100.000	215.782	215.566	216.192	215.566	216.002	216.041
104.530	215.884	215.670	216.298	215.670	216.095	216.145
106.325	215.925	215.711	216.340	215.711	216.132	216.182
112.433	216.063	215.851	216.482	215.851	216.238	216.306
113.030	216.076	215.841	216.472	215.841	216.238	216.316
120.000	216.233					216.460
140.000	216.683					216.859
160.000	217.134					217.519
163.030	217.202					217.572

MADISONS AVENUE LONGITUDINAL SECTION

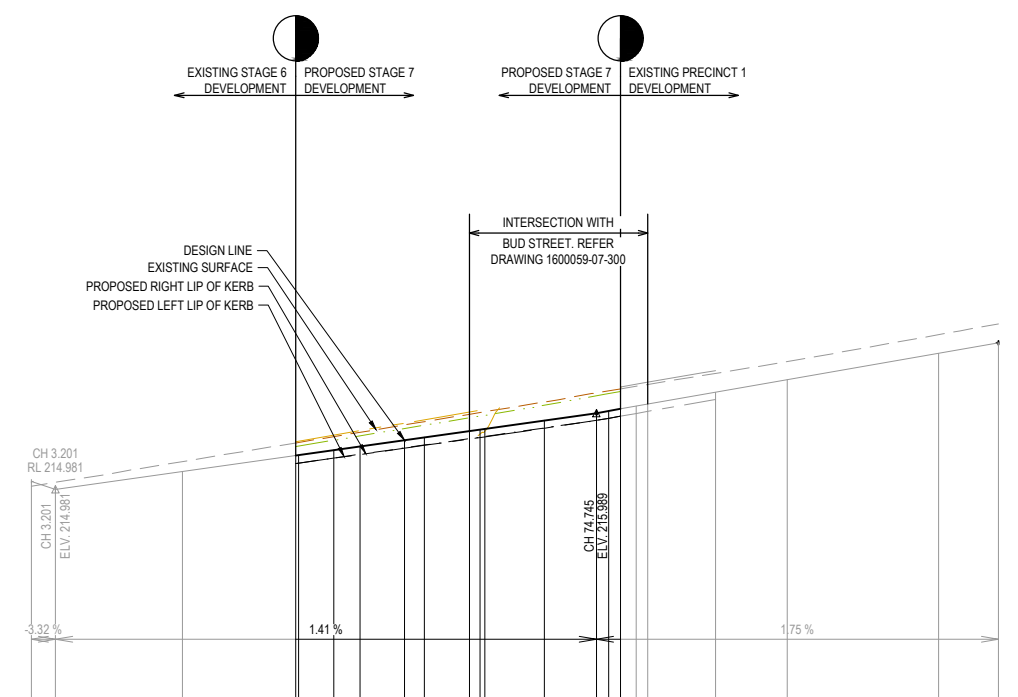

CHAINAGE	DESIGN CENTRELINE	RIGHT LIP OF KERB	EXISTING SURFACE AT RIGHT BOUNDARY	LEFT LIP OF KERB	EXISTING SURFACE AT LEFT BOUNDARY	EXISTING SURFACE
0.000	215.068					215.024
3.201	214.981					215.074
20.000	215.218					215.349
34.969	215.429	215.322	215.554	215.322	215.617	215.595
35.356	215.434	215.328	215.564	215.328	215.631	215.601
40.000	215.500	215.394	215.594	215.394	215.678	215.678
43.461	215.549	215.444	215.688	215.444	215.736	215.735
49.356	215.632	215.528	215.786	215.528	215.856	215.832
51.983	215.669	215.566	215.829	215.566	215.901	215.875
57.944	215.753	215.652	215.927	215.652	216.002	215.973
58.356	215.762	215.661	215.937	215.661	216.002	215.995
60.000	215.772	215.661	215.937	215.661	216.002	216.007
67.856	215.882	215.794	216.093	215.794	216.136	216.136
74.745	215.995	215.892	216.219	215.892	216.257	216.257
76.358	216.017	215.921	216.248	215.921	216.284	216.284
77.921	216.045	215.938	216.248	215.938	216.334	216.309
80.000	216.081	216.017	216.248	216.017	216.372	216.343
81.550	216.108	216.017	216.248	216.017	216.400	216.368
90.056	216.264					216.514
100.000	216.430					216.670
120.000	216.780					217.026
127.921	216.918					217.170

VIOLETTA BOULEVARD LONGITUDINAL SECTION

ISSUED FOR CONSTRUCTION

REV	DESCRIPTION	DATE	DRN.	APP.	REV	DESCRIPTION	DATE	DRN.	APP.
B	DRAWING INDEX UPDATED	28.03.22	DZ	SM					
A	ISSUED FOR CONSTRUCTION	07.12.21	NT	RW					
P2	ISSUED FOR REVIEW	12.10.21	LS	RW					
P1	ISSUED FOR TENDER	01.09.21	LS	RW					

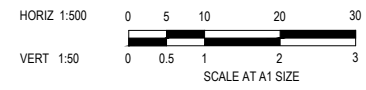

Designed: S. GILBERT
Date: 23.08.21
Drawn: L. SUTHERLAND
Approved: R. WICKETT
Date: 7.10.2021
PS Number: PS 822978N/53



Project Details: DAVIS VINEYARD - STAGE 7 AUST. INVESTMENT & DEVELOPMENT P/L CITY OF MELTON
Drawing Title: ROAD LONGITUDINAL SECTIONS MADISONS AVENUE & VIOLETTA BOULEVARD

Sheet 08 of 17
Scale: 1:500 H 1:50 V @ A1
Project Ref: 1600059
Stage No: 07
Drawing No: 101
Rev: B

K:\Jobs Data\1600059 Diggers Rest_Eng\Precinct 2\Stage 7\Drawings\1600059-07-100-RLS.dwg

STRUCTURAL FILL REQUIRED UNDER PAVEMENT AND FOOTPATHS WHERE CONSTRUCTED ABOVE NATURAL SURFACE. REFER GEOTECH REPORT FOR SPECIFICATION

LEGEND

--- EXISTING SURFACE
 — DESIGN SURFACE
 [Hatched Box] STRUCTURAL FILL

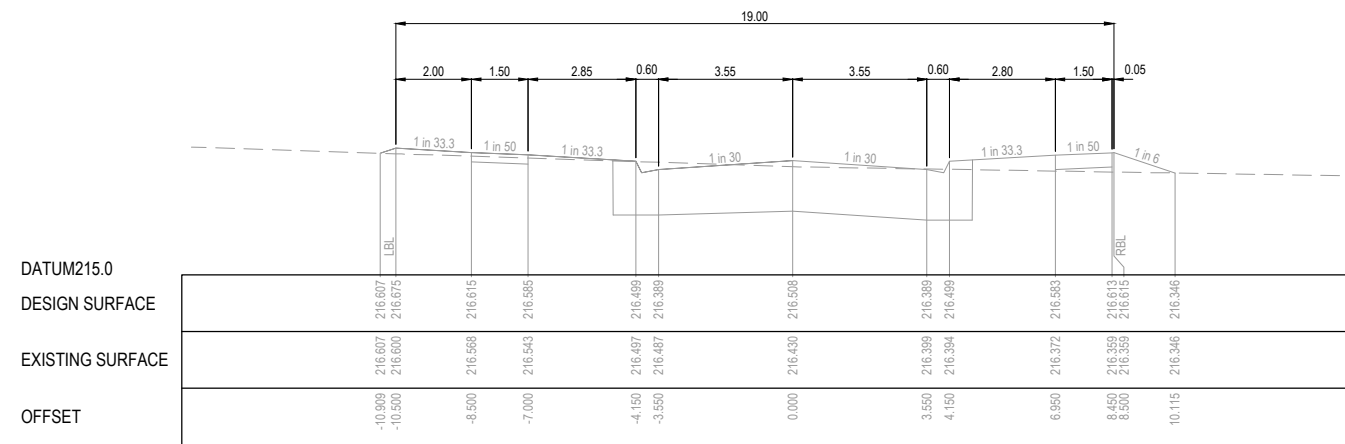

CH 40.546 (MATCH TO EXISTING)

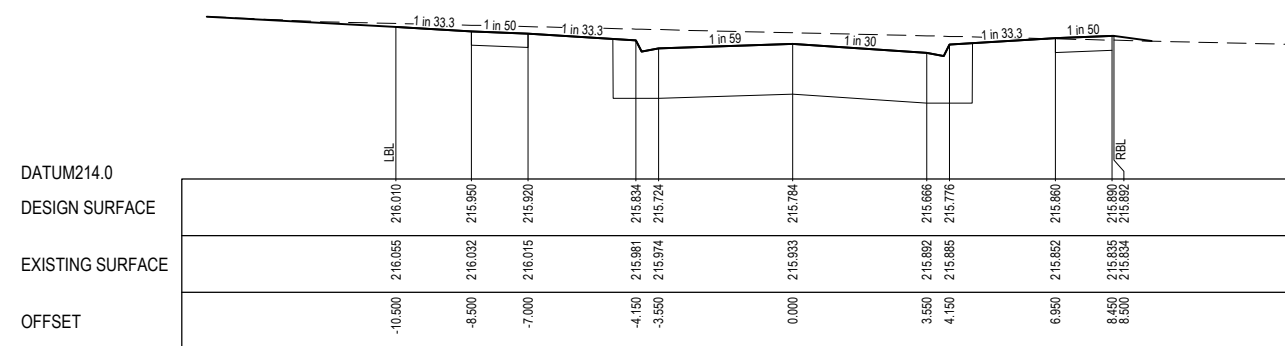

LTPCH 14.063

ISSUED FOR CONSTRUCTION

© COPYRIGHT All rights reserved Beveridge Williams & Co. Pty Ltd has granted a licence to the principle to use this document for its intended purpose. No unauthorised copying is permitted									
REV	DESCRIPTION	DATE	DRN.	APP.	REV	DESCRIPTION	DATE	DRN.	APP.
A	ISSUED FOR CONSTRUCTION	07.12.21	NT	RW					
P2	ISSUED FOR REVIEW	12.10.21	LS	RW					
P1	ISSUED FOR TENDER	01.09.21	LS	RW					

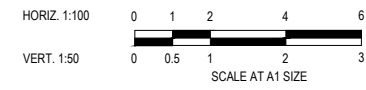

Designed Date: S. GILBERT 23.08.21
 Drawn: L. SUTHERLAND
 Approved Date: R. WICKETT 7.10.2021
 PS Number: PS 822978N/S3

BW Beveridge Williams
 1 Glenferrie Road
 Malvern VIC 3144
 ph: 03 9524 8888
 www.beveridgewilliams.com.au

Project Details: DAVIS VINEYARD - STAGE 7
 AUST. INVESTMENT & DEVELOPMENT P/L
 CITY OF MELTON
 Drawing Title: ROAD CROSS SECTIONS
 AVIATION DRIVE

Sheet 09 of 17	
Scale: 1:100 H 1:50 V @ A1	
Project Ref: 1600059	Stage No: 07
Drawing No: 200	Rev: A

STRUCTURAL FILL REQUIRED UNDER PAVEMENT AND FOOTPATHS WHERE CONSTRUCTED ABOVE NATURAL SURFACE. REFER GEOTECH REPORT FOR SPECIFICATION

LEGEND

- EXISTING SURFACE
- DESIGN SURFACE
- ▨ STRUCTURAL FILL

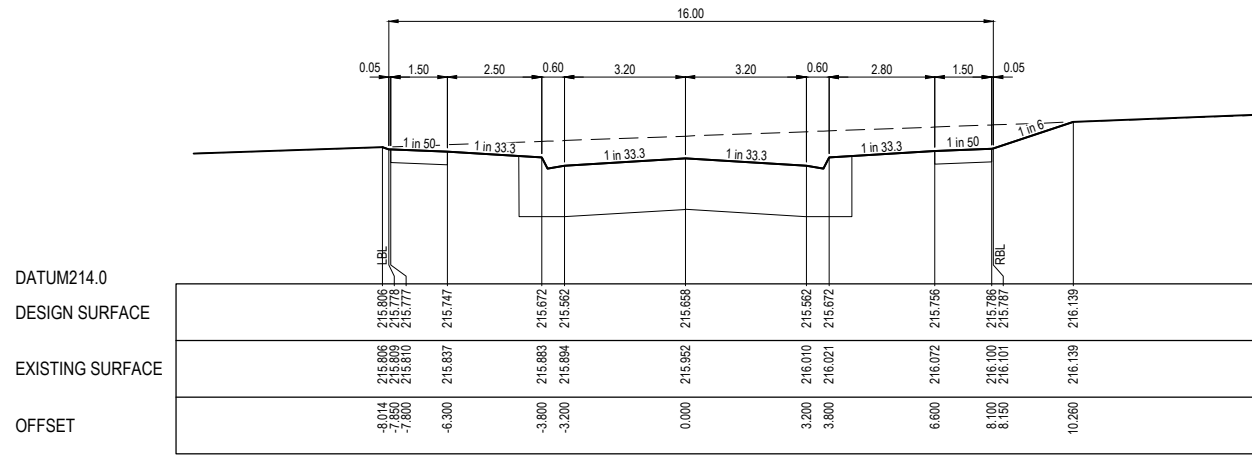

CH 75.050

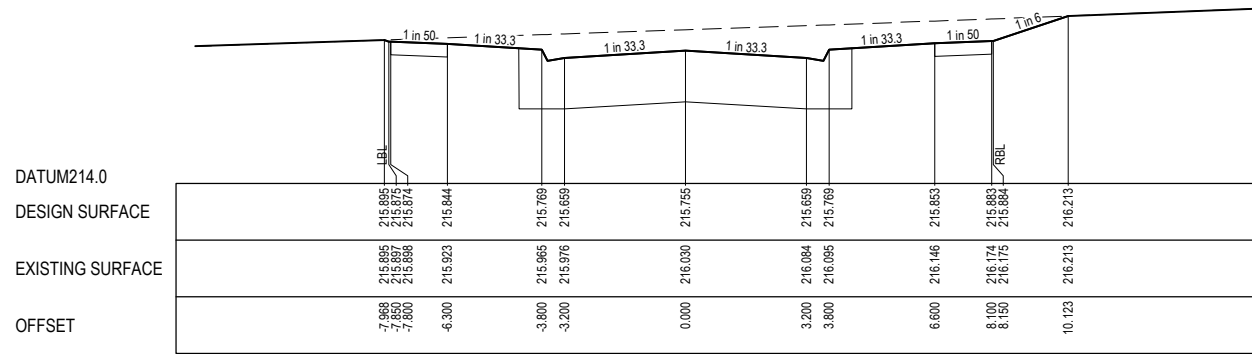

CH 55.677

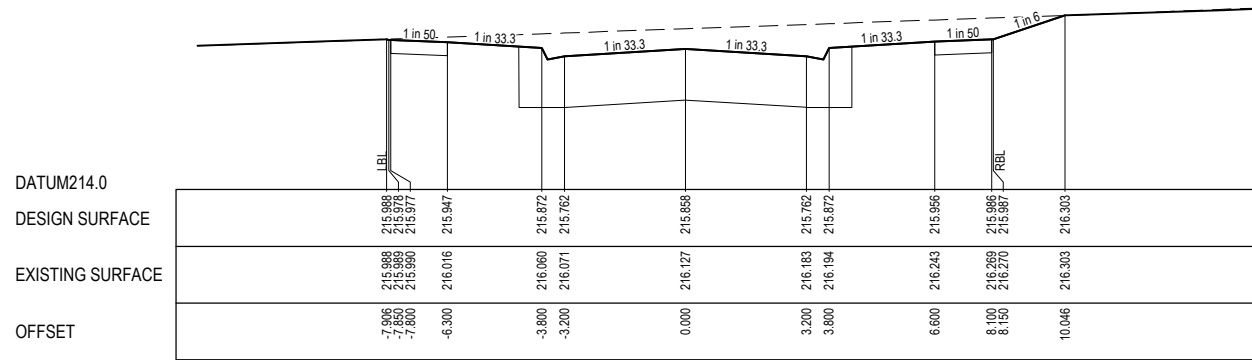

CH 35.033

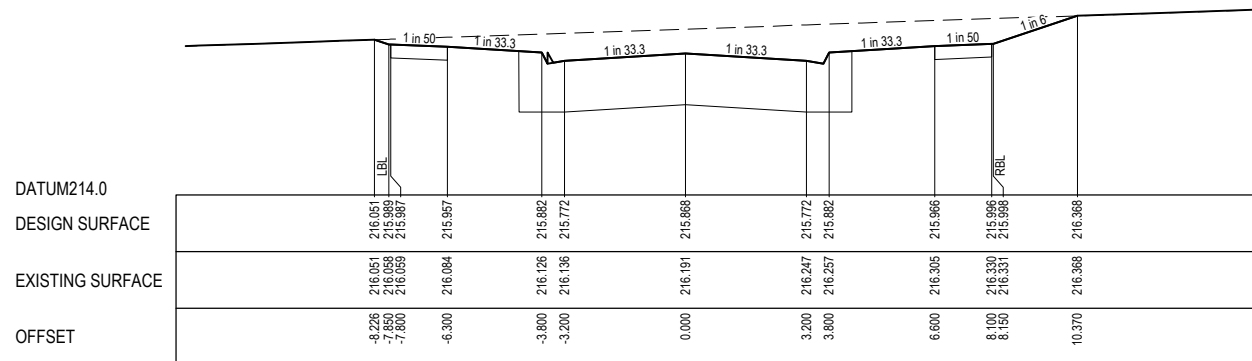

LTPCH 12.075

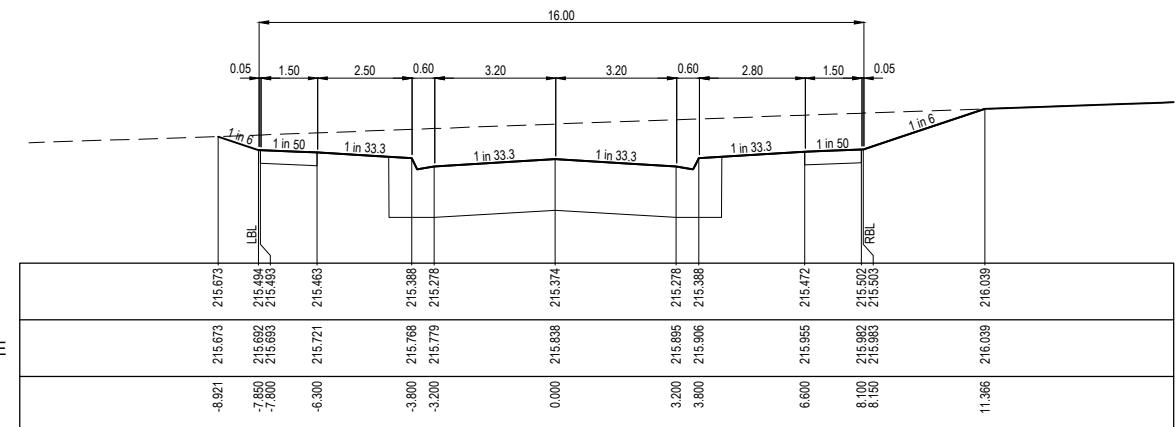

RTPCH 131.921

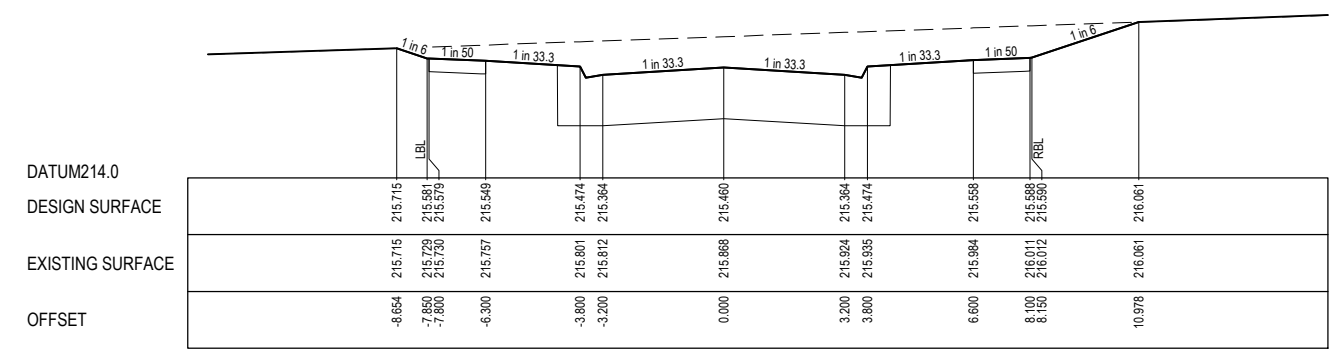

CH 114.561

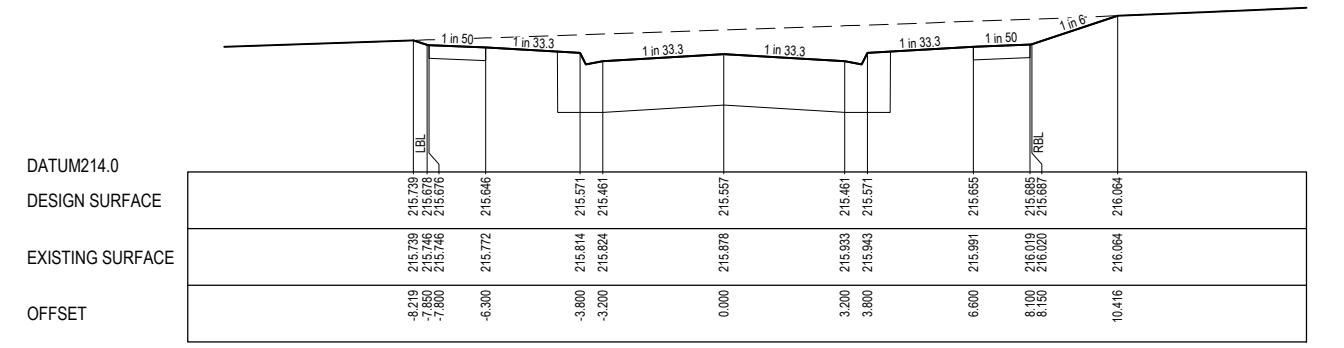

CH 95.188

ISSUED FOR CONSTRUCTION

© COPYRIGHT All rights reserved Beveridge Williams & Co. Pty Ltd has granted a licence to the principle to use this document for its intended purpose. No unauthorized copying is permitted					
REV	DESCRIPTION	DATE	DRN.	APP.	REV.
A	ISSUED FOR CONSTRUCTION	07.12.21	NT	RW	
P2	ISSUED FOR REVIEW	12.10.21	LS	RW	
P1	ISSUED FOR TENDER	01.09.21	LS	RW	

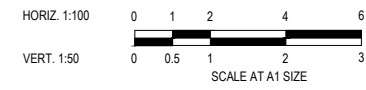

Designed: S. GILBERT
Date: 23.08.21
Drawn: L. SUTHERLAND
Approved: R. WICKETT
Date: 7.10.2021
PS Number: PS 822978N/S3

Beveridge Williams
1 Glenferrie Road
Malvern VIC 3144
ph: 03 9524 8888
www.beveridgewilliams.com.au



Project Details: DAVIS VINEYARD - STAGE 7
AUST. INVESTMENT & DEVELOPMENT P/L
CITY OF MELTON
Drawing Title: ROAD CROSS SECTIONS
BUD STREET

Sheet 10 of 17
Scale: 1:100 H 1:50 V @ A1
Project Ref: 1600059
Stage No: 07
Drawing No: 201
Rev: A

K:\Jobs Data\1600059 Diggers Rest_Eng\Precond 2\Stage 7\Drawings\1600059-07-200-RXS.dwg

STRUCTURAL FILL REQUIRED UNDER PAVEMENT AND FOOTPATHS WHERE CONSTRUCTED ABOVE NATURAL SURFACE. REFER GEOTECH REPORT FOR SPECIFICATION

LEGEND

-  EXISTING SURFACE
-  DESIGN SURFACE
-  STRUCTURAL FILL

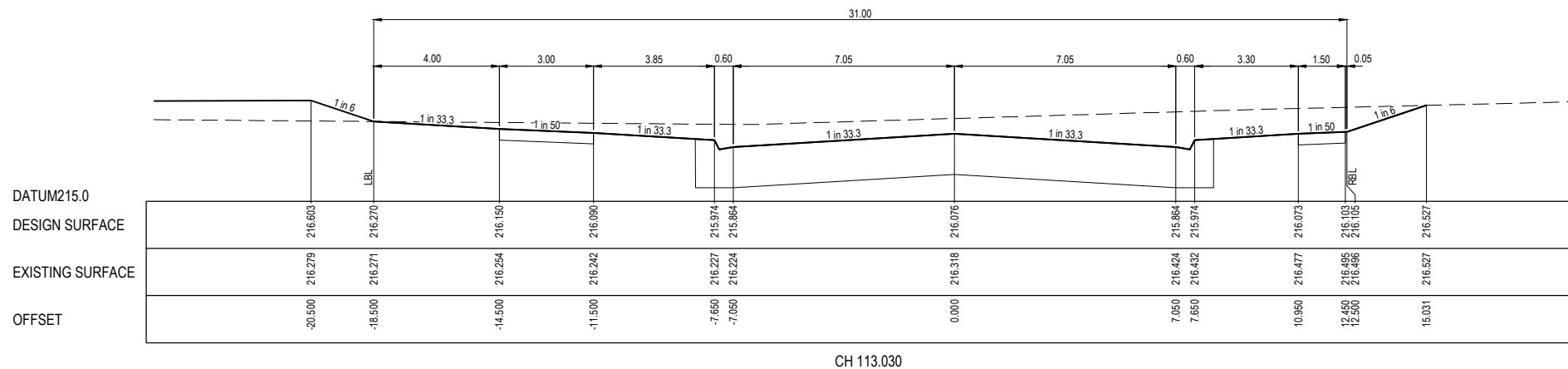

CH 113.030

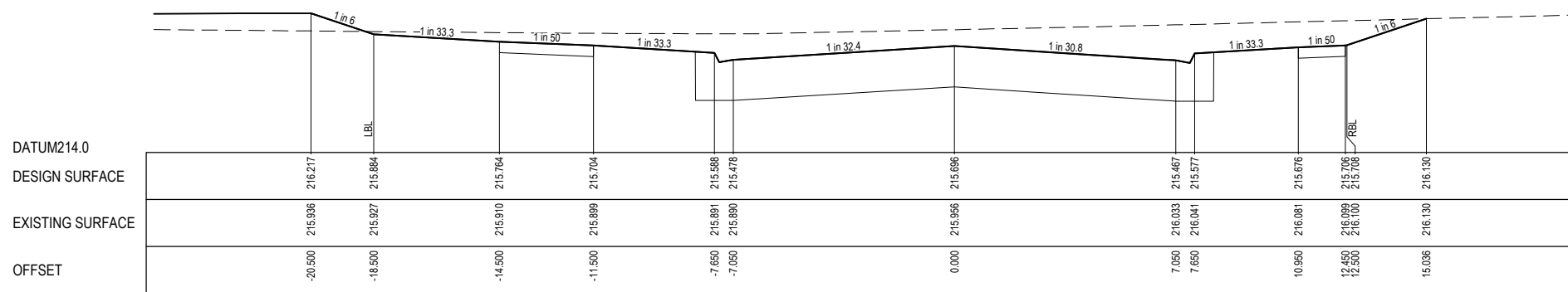

RTPCH 96.019

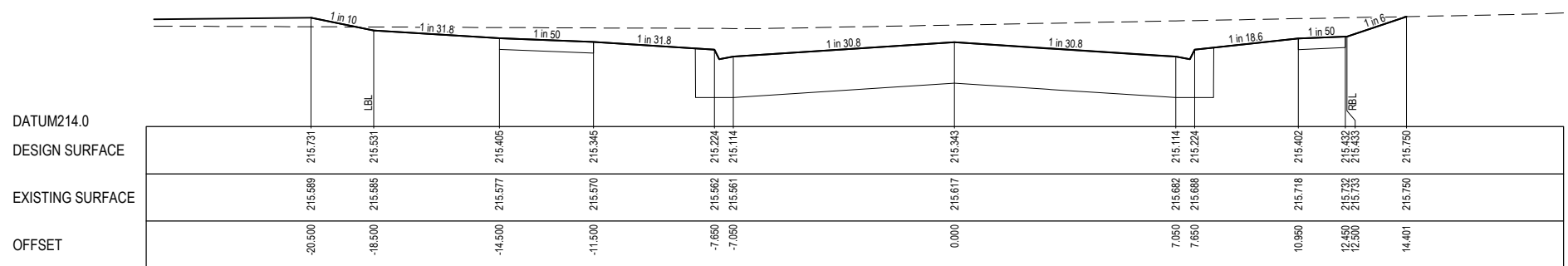

RTPCH 66.600

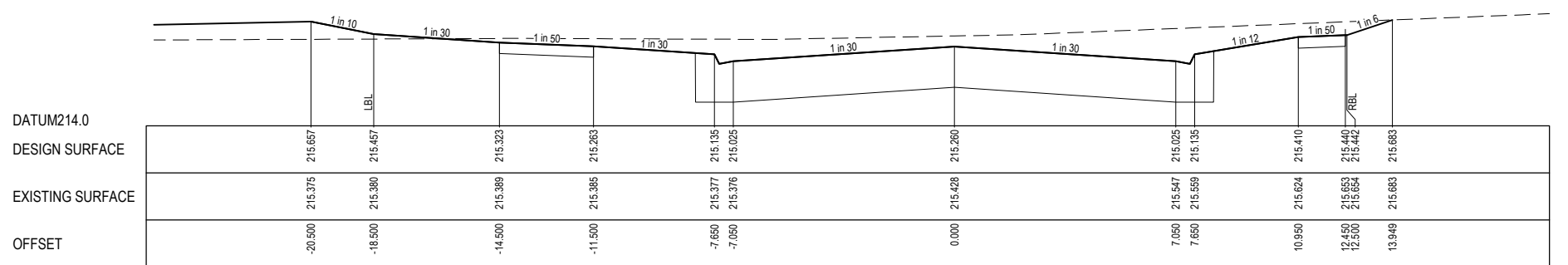

CH 50.000

ISSUED FOR CONSTRUCTION

© COPYRIGHT All rights reserved Beveridge Williams & Co. Pty Ltd has granted a licence to the principle to use this document for its intended purpose. No unauthorized copying is permitted.									
REV	DESCRIPTION	DATE	DRN.	APP.	REV	DESCRIPTION	DATE	DRN.	APP.
A	ISSUED FOR CONSTRUCTION	07.12.21	NT	RW					
P2	ISSUED FOR REVIEW	12.10.21	LS	RW					
P1	ISSUED FOR TENDER	01.09.21	LS	RW					

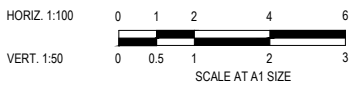

Designed: S. GILBERT
Date: 23.08.21
Drawn: L. SUTHERLAND
Approved: R. WICKETT
Date: 7.10.2021
PS Number: PS 822978N/S3

Beveridge Williams
1 Glenferrie Road
Malvern VIC 3144
ph: 03 9524 8888
www.beveridgewilliams.com.au



Project Details:
DAVIS VINEYARD - STAGE 7
AUST. INVESTMENT & DEVELOPMENT P/L
CITY OF MELTON
Drawing Title:
ROAD CROSS SECTIONS
MADISONS AVENUE

Sheet 11 of 17
Scale:
1:100 H 1:50 V @ A1
Project Ref: 1600059
Stage No: 07
Drawing No: 202
Rev: A

K:\Jobs Data\1600059 Diggers Rest_Eng\Precond 2\Stage 7\Drawings\1600059-07-200-RXS.dwg

STRUCTURAL FILL REQUIRED UNDER PAVEMENT AND FOOTPATHS WHERE CONSTRUCTED ABOVE NATURAL SURFACE. REFER GEOTECH REPORT FOR SPECIFICATION

LEGEND

-  EXISTING SURFACE
-  DESIGN SURFACE
-  STRUCTURAL FILL

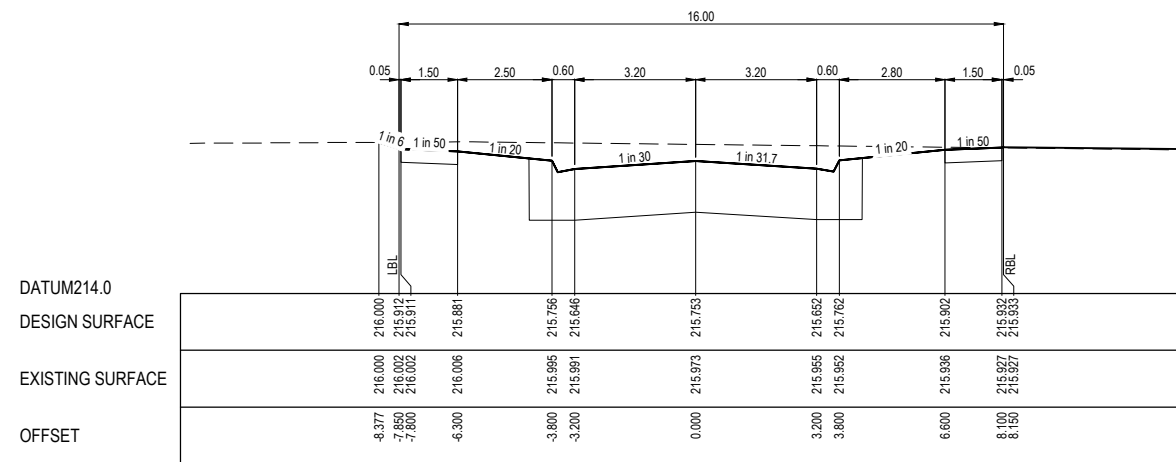

LTPCH 57.944

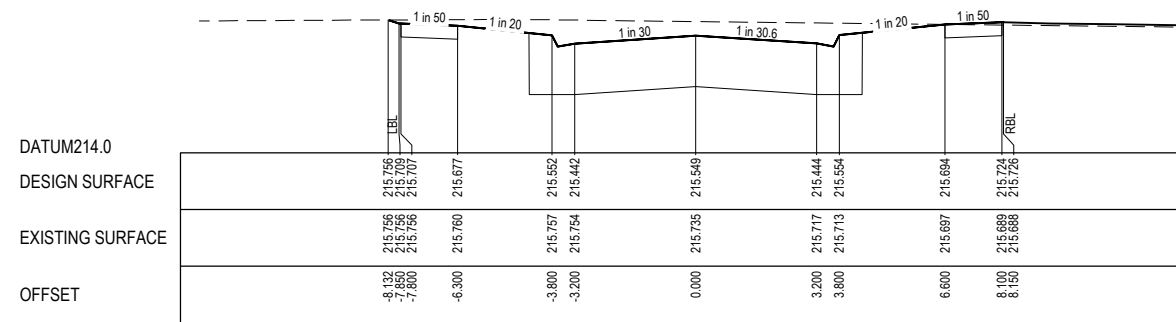

CH 43.481

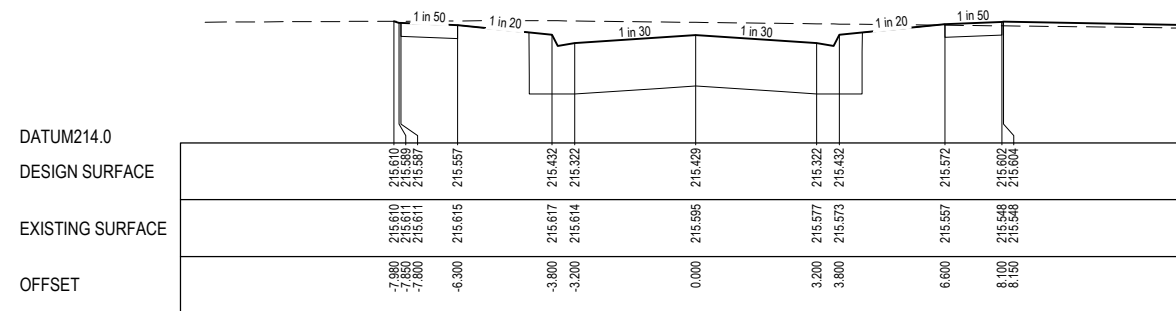

CH 34.969

ISSUED FOR CONSTRUCTION

© COPYRIGHT All rights reserved Beveridge Williams & Co. Pty Ltd has granted a licence to the principle to use this document for its intended purpose. No unauthorised copying is permitted						
B	DRAWING INDEX UPDATED	28.03.22	DZ	SM		
A	ISSUED FOR CONSTRUCTION	07.12.21	NT	RW		
P2	ISSUED FOR REVIEW	12.10.21	LS	RW		
P1	ISSUED FOR TENDER	01.09.21	LS	RW		
REV	DESCRIPTION	DATE	DRN.	APP.	REV	DESCRIPTION

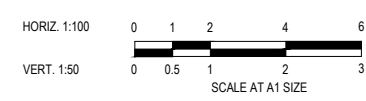

Designed	S. GILBERT
Date	23.08.21
Drawn	L. SUTHERLAND
Approved	R. WICKETT
Date	7.10.2021
PS Number	PS 822978N/53

Beveridge Williams

1 Glenferrie Road
Malvern VIC 3144
ph: 03 9524 8888
www.beveridgewilliams.com.au

Project Details	DAVIS VINEYARD - STAGE 7 AUST. INVESTMENT & DEVELOPMENT P/L CITY OF MELTON
Drawing Title	ROAD CROSS SECTIONS VIOLETTA BOULEVARD

Sheet 12 of 17			
Scale 1:100 H 1:50 V @ A1			
Project Ref	Stage No	Drawing No	Rev
1600059	07	203	B

K:\Jobs Data\1600059 Diggers Rest_Eng\Precond 2\Stage 7\Drawings\1600059-07-200-RXS.dwg

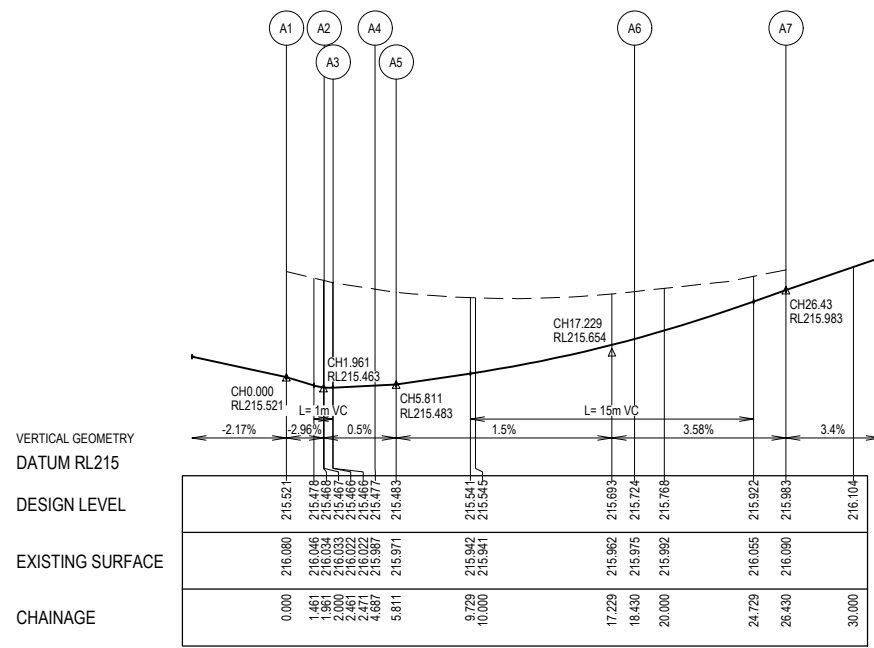

LIP LINE A

Point no	Easting	Northing	RL
A1	297094.177	5834113.488	215.521
A2	297093.925	5834111.504	215.467
A3	297093.698	5834111.105	215.466
A4	297091.946	5834109.748	215.477
A5	297091.481	5834108.770	215.483
A6	297099.401	5834100.408	215.724
A7	297107.376	5834099.778	215.983

Curve no	I	Radius	Arc	A	B	X	Y	I	Mid point RL
A2 - A3	44.997	0.600	0.471	0.046	0.034	0.117	0.113	0.118	215.466
A4 - A5	53.639	1.200	1.123	0.129	0.095	0.278	0.263	0.281	215.480
A5 - A6	84.076	8.600	12.620	2.213	1.641	3.085	2.674	3.155	215.581

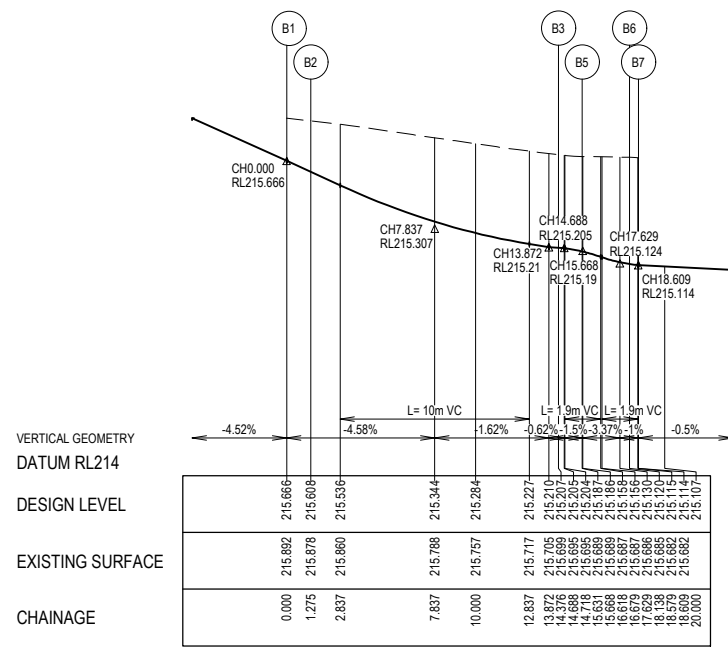

LIP LINE B

LIP LINE B

Point no	Easting	Northing	RL
B1	297098.842	5834093.330	215.666
B2	297097.571	5834093.430	215.608
B3	297088.362	5834085.940	215.207
B4	297088.323	5834085.630	215.205
B5	297088.565	5834084.744	215.187
B6	297090.100	5834082.762	215.120
B7	297090.221	5834082.319	215.114

Curve no	I	Radius	Arc	A	B	X	Y	I	Mid point RL
B2 - B3	67.283	8.600	13.101	2.376	1.760	3.197	2.739	3.275	215.345
B4 - B5	45.000	1.200	0.942	0.091	0.068	0.234	0.225	0.236	215.197
B6 - B7	45.000	0.600	0.471	0.046	0.034	0.117	0.113	0.118	215.117

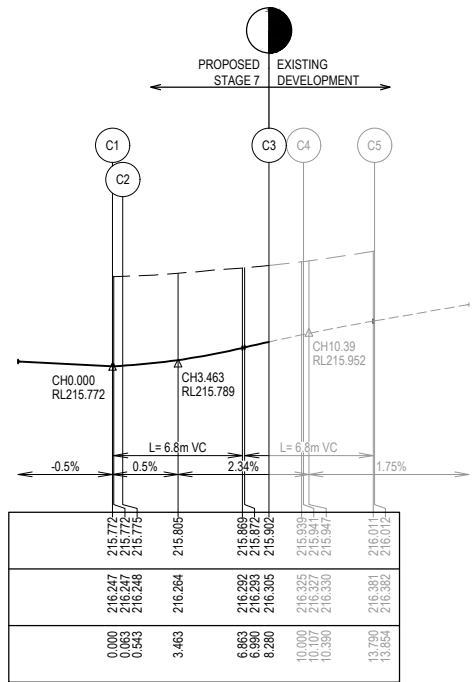
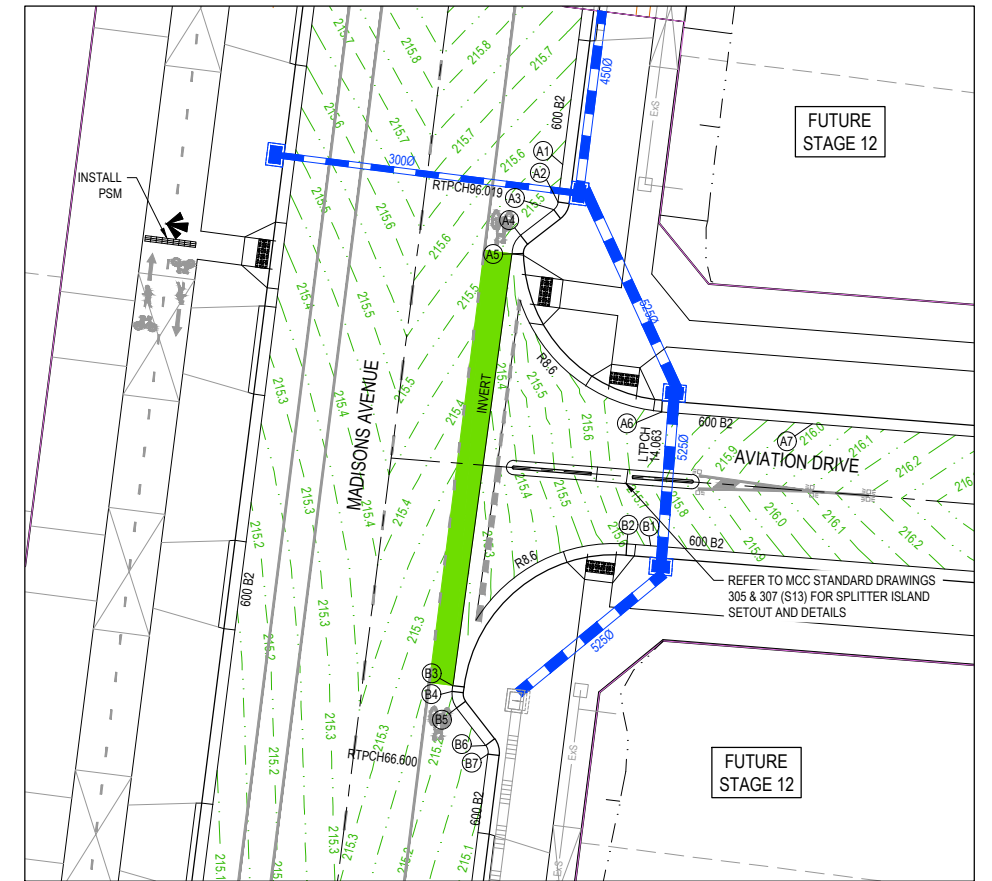

LIP LINE C

LIP LINE C

Point no	Easting	Northing	RL
C1	296993.948	5834124.786	215.772
C2	296994.488	5834124.730	215.775
C3	297001.522	5834127.270	215.902
C4	297002.652	5834128.702	215.941
C5	297003.906	5834132.201	216.012

Curve no	I	Radius	Arc	A	B	X	Y	I	Mid point RL
G2 - G3	63.721	8.600	9.564	1.296	0.965	2.360	2.179	2.391	215.836
G3 - G4	24.961	8.600	3.747	0.203	0.152	0.935	0.924	0.937	215.978

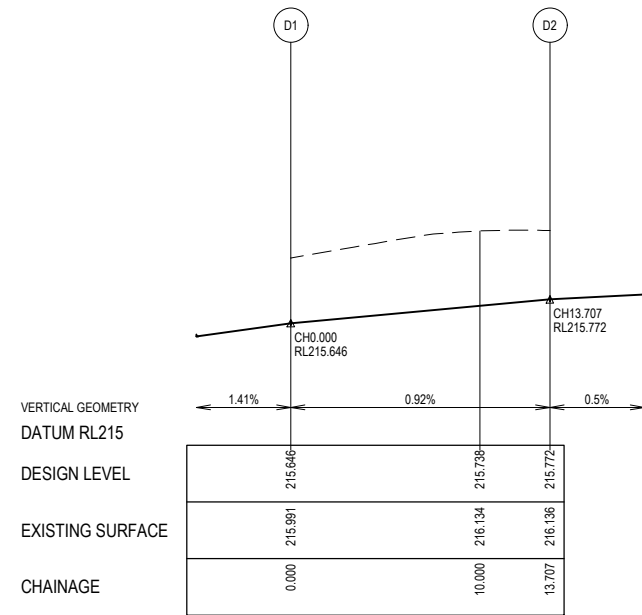

LIP LINE D

LIP LINE D

Point no	Easting	Northing	RL
D1	297000.934	5834108.783	215.646
D2	296993.289	5834118.420	215.772

Curve no	I	Radius	Arc	A	B	X	Y	I	Mid point RL
D1 - D2	91.318	8.600	13.707	2.589	1.916	3.337	2.814	3.427	215.709

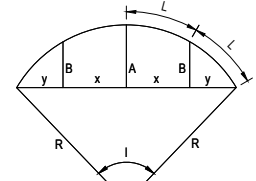

LEGEND

- STORMWATER DRAIN, PIT & PROPERTY INLET
- MELBOURNE WATER DRAIN & PIT
- SWALE DRAIN
- SEWER & MAINTENANCE STRUCTURES
- HOUSE DRAIN
- TACTILE PAVERS (INDICATIVE ONLY)
- EXISTING HOUSE DRAIN
- RETAINING WALL
- PAVEMENT TREATMENT
- CONCRETE EDGE STRIP WITH SUBSOIL DRAIN, "NO ROAD" SIGN & BARRIER
- LIMIT OF WORKS
- EXISTING TREE TO BE REMOVED
- PERMANENT SURVEY MARK
- TEMPORARY BENCH MARK
- PROPOSED DRIVEWAY

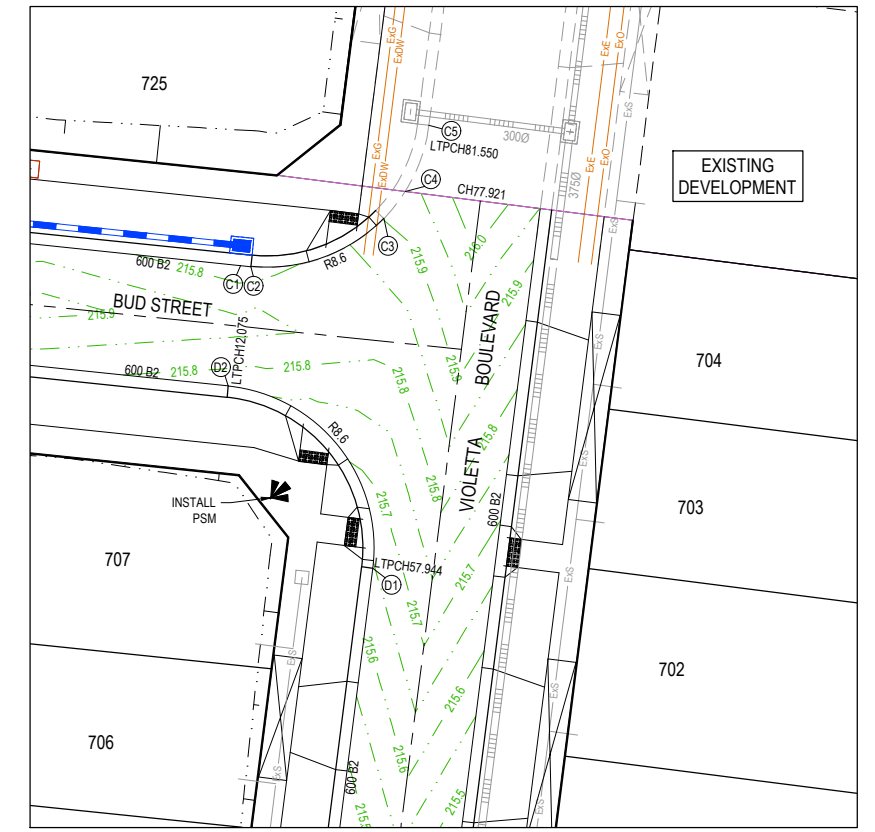

ISSUED FOR CONSTRUCTION

© COPYRIGHT All rights reserved
Beveridge Williams & Co. Pty Ltd has granted a licence to the principle to use this document for its intended purpose.
No unauthorised copying is permitted

REV	DESCRIPTION	DATE	DRN.	APP.	REV	DESCRIPTION	DATE	DRN.	APP.
C	DRAWING INDEX UPDATED	28.03.22	DZ	SM					
B	VIOLETTA PRAM CROSSING ADDED	25.02.22	NT	RW					
A	ISSUED FOR CONSTRUCTION	07.12.21	NT	RW					
P2	ISSUED FOR REVIEW	12.10.21	LS	RW					
P1	ISSUED FOR TENDER	01.09.21	LS	RW					

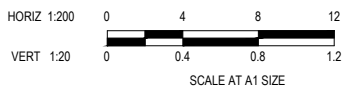

Designed Date: S. GILBERT 23.08.21
Drawn: L. SUTHERLAND
Approved Date: R. WICKETT 7.10.2021
PS Number: PS 822978/NS3

BW Beveridge Williams
1 Glenferrie Road
Malvern VIC 3144
ph: 03 9524 8888
www.beveridgewilliams.com.au

Project Details: DAVIS VINEYARD - STAGE 7
AUST. INVESTMENT & DEVELOPMENT P/L
CITY OF MELTON
Drawing Title: INTERSECTION DETAILS
(SHEET 1 OF 2)

Sheet 13 of 17			
Scale: 1:200 H 1:20 V @ A1			
Project Ref: 1600059	Stage No: 07	Drawing No: 300	Rev: C

K:\Jobs Data\1600059 Diggers Rest_Eng\Princind 2\Stage 7\Drawings\1600059-07-300-INT.dwg

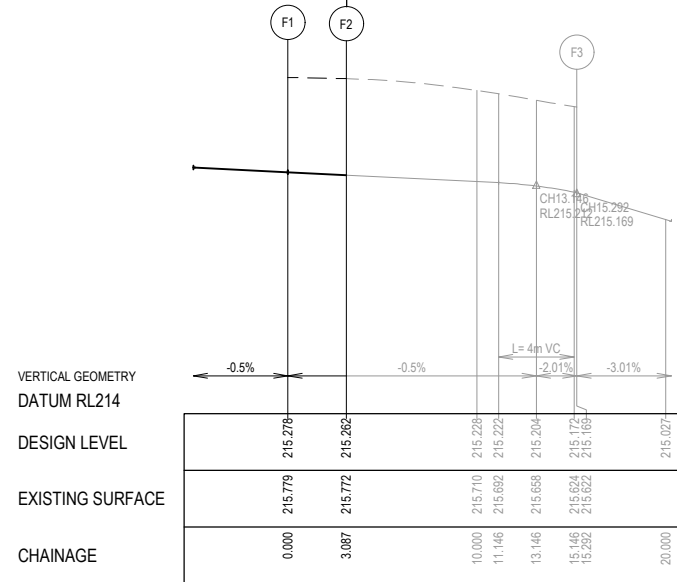
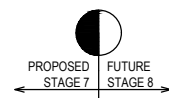

LIP LINE F

Point no	Easting	Northing	RL
F1	296874.080	5834130.771	215.278
F2	296871.009	5834131.089	215.262
F3	296861.801	5834124.703	215.169

Curve no	I	Radius	Arc	A	B	X	Y	I	Mid point RL
F2 - F3	81.313	8.600	12.205	2.076	1.540	2.988	2.615	3.051	215.232

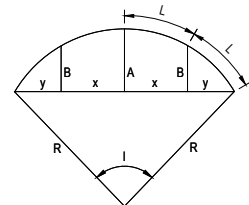

LIP PROFILE SETOUT

LEGEND

- STORMWATER DRAIN, PIT & PROPERTY INLET
- MELBOURNE WATER DRAIN & PIT
- SWALE DRAIN
- SEWER & MAINTENANCE STRUCTURES
- HOUSE DRAIN
- TACTILE PAVERS (INDICATIVE ONLY)
- EXISTING HOUSE DRAIN
- RETAINING WALL
- PAVEMENT TREATMENT
- CONCRETE EDGE STRIP WITH SUBSOIL DRAIN
- "NO ROAD" SIGN & BARRIER
- LIMIT OF WORKS
- EXISTING TREE TO BE REMOVED
- PERMANENT SURVEY MARK
- TEMPORARY BENCH MARK
- PROPOSED DRIVEWAY

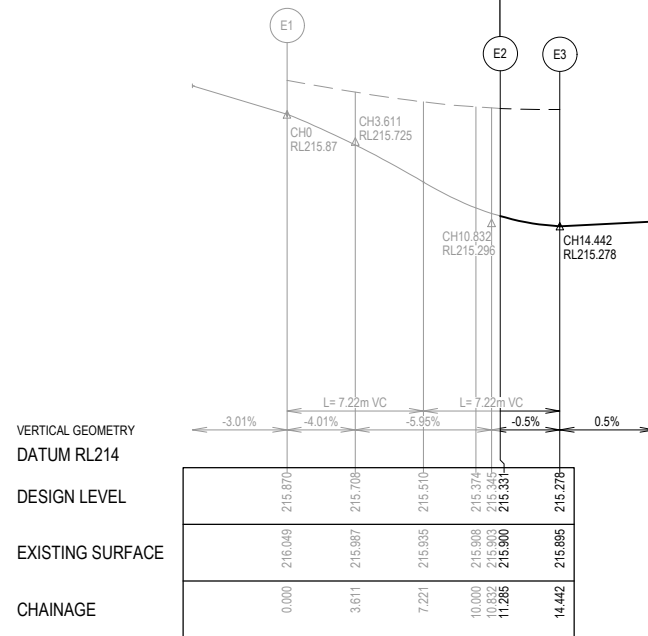
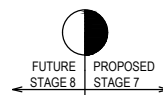

LIP LINE E

Point no	Easting	Northing	RL
E1	296867.218	5834147.499	215.870
E2	296871.728	5834138.025	215.331
E3	296874.740	5834137.137	215.278

Curve no	I	Radius	Arc	A	B	X	Y	I	Mid point RL
E1 - E2	75.182	8.600	11.285	1.785	1.327	2.771	2.475	2.821	215.601
E2 - E3	21.037	8.600	3.158	0.145	0.108	0.788	0.782	0.789	215.295

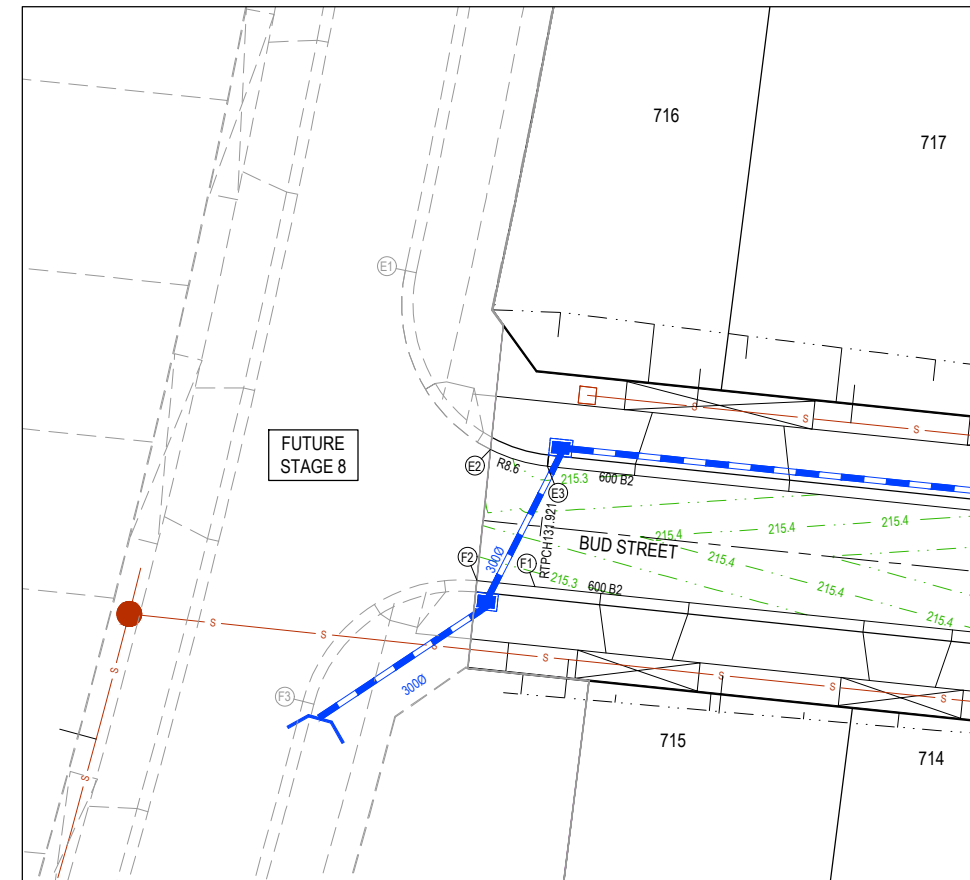

ISSUED FOR CONSTRUCTION

© COPYRIGHT All rights reserved
Beveridge Williams & Co. Pty Ltd has granted a licence to the principle to use this document for its intended purpose.
No unauthorised copying is permitted

REV	DESCRIPTION	DATE	DRN.	APP.	REV	DESCRIPTION	DATE	DRN.	APP.
A	ISSUED FOR CONSTRUCTION	07.12.21	NT	RW					
P2	ISSUED FOR REVIEW	12.10.21	LS	RW					
P1	ISSUED FOR TENDER	01.09.21	LS	RW					

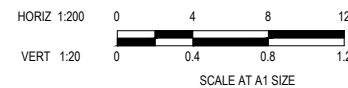

Designed: S. GILBERT
Date: 23.08.21
Drawn: L. SUTHERLAND
Approved: R. WICKETT
Date: 7.10.2021
PS Number: PS 822978N/S3

BW Beveridge Williams
1 Glenferrie Road
Malvern VIC 3144
ph: 03 9524 8888
www.beveridgewilliams.com.au

Project Details: DAVIS VINEYARD - STAGE 7
AUST. INVESTMENT & DEVELOPMENT P/L
CITY OF MELTON
Drawing Title: INTERSECTION DETAILS
(SHEET 2 OF 2)

Sheet 14 of 17

Scale: 1:200 H 1:20 V @ A1

Project Ref: 1600059
Stage No: 07
Drawing No: 301
Rev: A



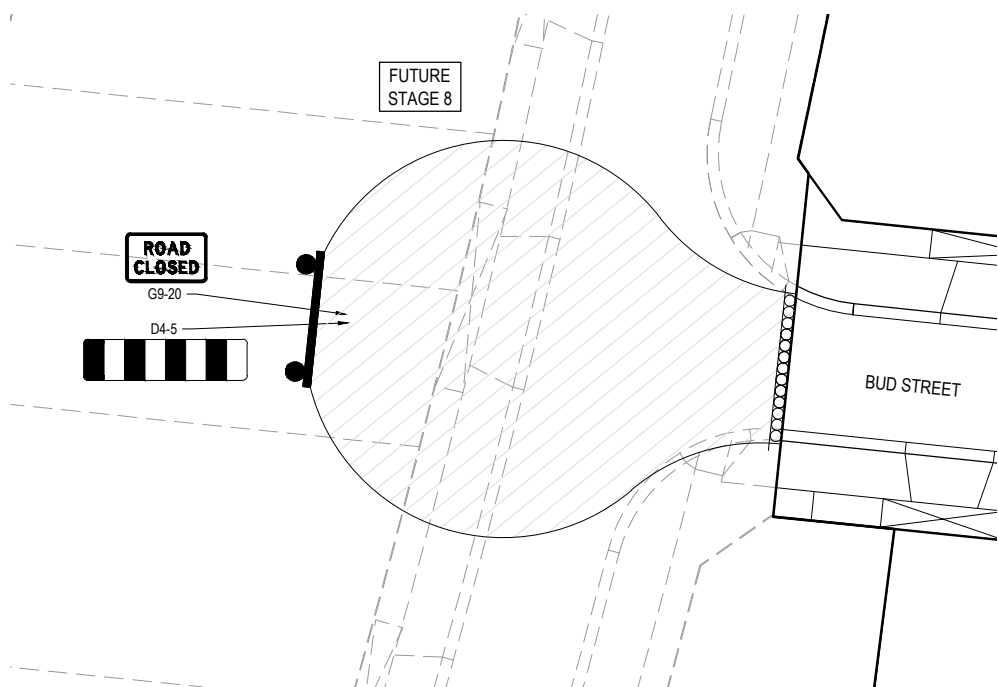
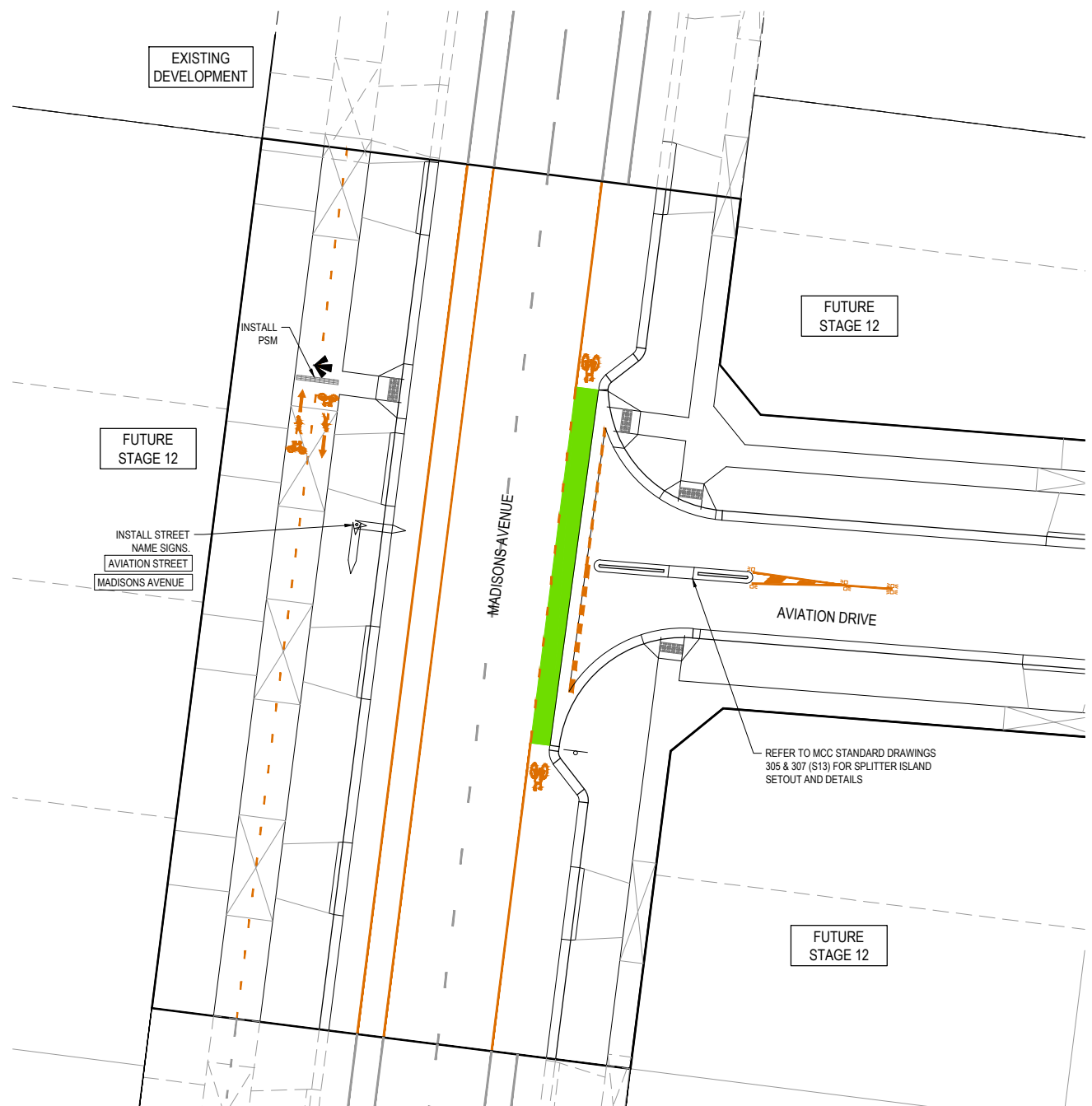
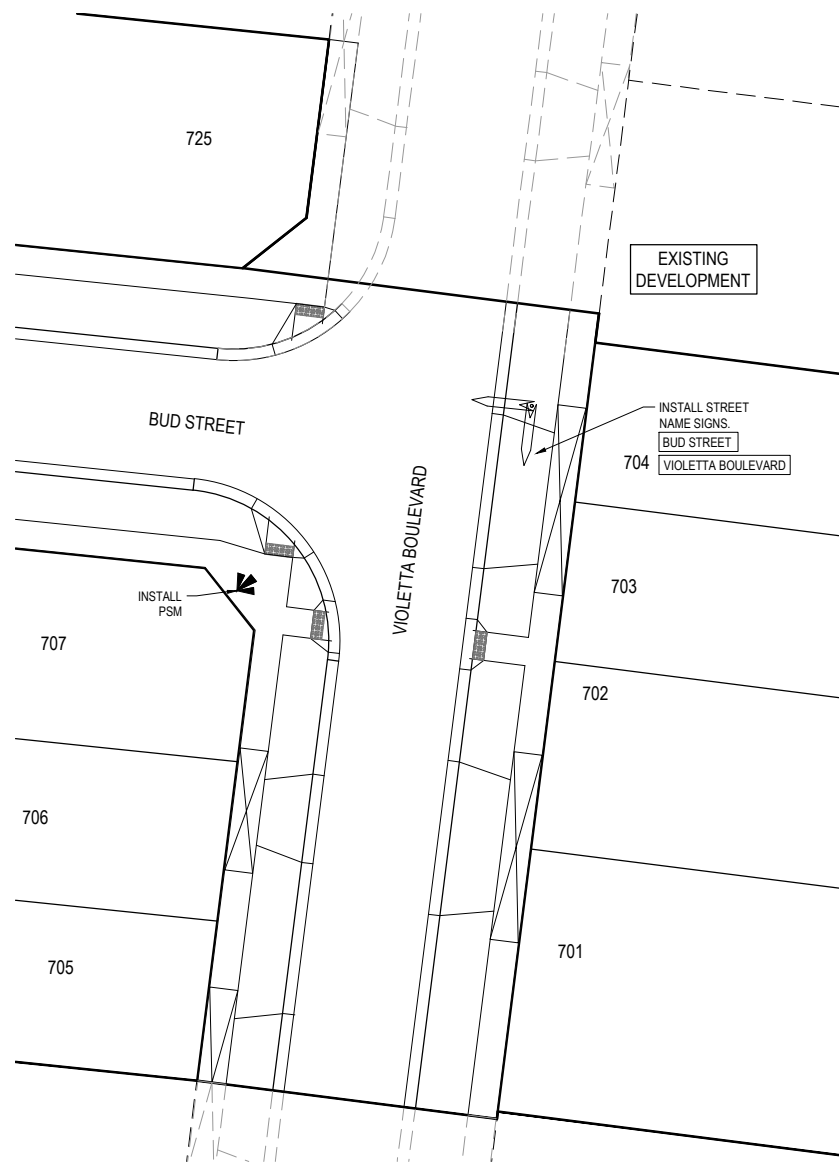

- NOTES**
1. RRPMS AT MAX 6m SPACING.
 2. LINEMARKING TO BE EXTENDED AT LEAST 6m FROM THE TANGENT POINT
 3. LINEMARKING IN ACCORDANCE WITH AS1742.
 4. TGSIs TO BE INSTALLED IN ACCORDANCE WITH VICROADS RDN 06-06 - JULY 2010
 5. ALL STREET NAME SIGNS AT INTERSECTIONS TO INCLUDE RELEVANT STREET NUMBERING.
 6. ALL LINE MARKING PAINT SHALL BE LONG LIFE TYPE. LATERAL WORKS AND ARROWS BEING COLD APPLIED PLASTIC TROWELLED INTO PLACE (MATERIAL DEGADUR PLASTELINE) AND LONGITUDINAL LINES BEING EXTRUDED THERMOPLASTIC MATERIAL.

ISSUED FOR CONSTRUCTION

© COPYRIGHT All rights reserved Beveridge Williams & Co. Pty Ltd has granted a licence to the principle to use this document for its intended purpose. No unauthorised copying is permitted.						
C	DRAWING INDEX UPDATED	28.03.22	DZ	SM		
B	VIOLETTA PRAM CROSSING ADDED	25.02.22	NT	RW		
A	ISSUED FOR CONSTRUCTION	07.12.21	NT	RW		
P2	ISSUED FOR REVIEW	12.10.21	LS	RW		
P1	ISSUED FOR TENDER	01.09.21	LS	RW		
REV	DESCRIPTION	DATE	DRN.	APP.	REV	



Designed Date: S. GILBERT 23.08.21
 Drawn: L. SUTHERLAND
 Approved Date: R. WICKETT 7.10.2021
 PS Number: PS 822978N/S3

BW Beveridge Williams
 1 Glenferrie Road
 Malvern VIC 3144
 ph: 03 9524 8888
 www.beveridgewilliams.com.au

Project Details: DAVIS VINEYARD - STAGE 7
 AUST. INVESTMENT & DEVELOPMENT P/L
 CITY OF MELTON
 Drawing Title: SIGNAGE & LINE MARKING PLANS

Sheet 15 of 17
 Scale: 1:200 @ A1
 Project Ref: 1600059
 Stage No: 07
 Drawing No: 350
 Rev: C

NOTES:
 ALL STORMWATER DRAINS UP TO AND INCLUDING 750mm DIA. ARE TO BE CLASS 2 R.R.J. PIPES UNLESS NOTED OTHERWISE.

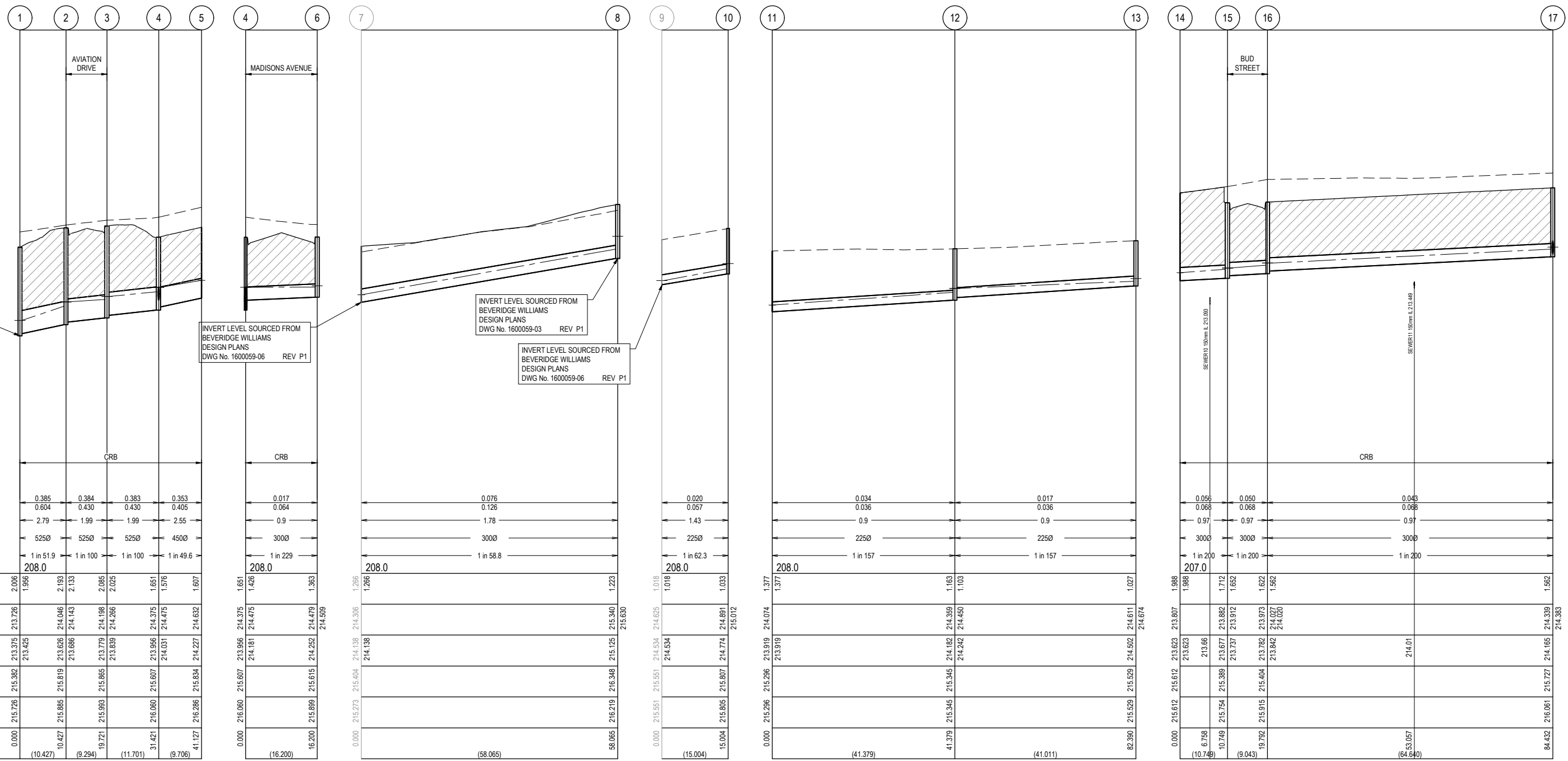
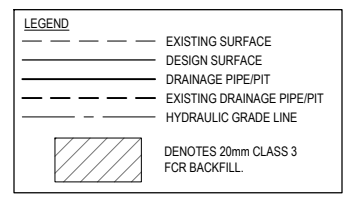

INVERT LEVEL SOURCED FROM BEVERIDGE WILLIAMS DESIGN PLANS DWG No. 1600059-06 REV P1

INVERT LEVEL SOURCED FROM BEVERIDGE WILLIAMS DESIGN PLANS DWG No. 1600059-06 REV P1

INVERT LEVEL SOURCED FROM BEVERIDGE WILLIAMS DESIGN PLANS DWG No. 1600059-03 REV P1

INVERT LEVEL SOURCED FROM BEVERIDGE WILLIAMS DESIGN PLANS DWG No. 1600059-06 REV P1

DESIGN FLOW (m ³ /s)	0.385	0.384	0.383	0.353
CAPACITY (m ³ /s)	0.604	0.430	0.430	0.405
AT GRADE VELOCITY (m/s)	2.79	1.99	1.99	2.55
PIPE SIZE (mm)	5250	5250	5250	4500
PIPE GRADE	1 in 51.9	1 in 100	1 in 100	1 in 49.6
DATUM	208.0			
DEPTH TO INVERT	2.006	1.956	2.193	1.651
H.G.L.	213.375	213.425	213.686	214.475
INVERT LEVEL	213.375	213.425	213.686	214.475
FINISHED SURFACE	215.382	215.819	215.865	215.807
EXISTING SURFACE	215.726	215.885	215.893	216.060
PIPE CHAINAGE (Reach Length)	0.000	10.427	19.721	31.421

DESIGN FLOW (m ³ /s)	0.017	0.076	0.020
CAPACITY (m ³ /s)	0.064	0.126	0.057
AT GRADE VELOCITY (m/s)	0.9	1.78	1.43
PIPE SIZE (mm) <td>3000</td> <td>3000</td> <td>2250</td>	3000	3000	2250
PIPE GRADE <td>1 in 229</td> <td>1 in 58.8</td> <td>1 in 62.3</td>	1 in 229	1 in 58.8	1 in 62.3
DATUM	208.0		
DEPTH TO INVERT	1.651	1.426	1.018
H.G.L.	214.375	214.475	214.625
INVERT LEVEL	214.181	214.475	214.534
FINISHED SURFACE	215.607	215.807	215.807
EXISTING SURFACE	216.060	216.348	216.805
PIPE CHAINAGE (Reach Length)	0.000	16.200	15.004

DESIGN FLOW (m ³ /s)	0.034	0.017
CAPACITY (m ³ /s)	0.036	0.036
AT GRADE VELOCITY (m/s)	0.9	0.9
PIPE SIZE (mm) <td>2250</td> <td>2250</td>	2250	2250
PIPE GRADE <td>1 in 157</td> <td>1 in 157</td>	1 in 157	1 in 157
DATUM	208.0	
DEPTH TO INVERT	1.377	1.027
H.G.L.	214.074	214.611
INVERT LEVEL	213.919	214.502
FINISHED SURFACE	215.296	215.529
EXISTING SURFACE	215.296	215.529
PIPE CHAINAGE (Reach Length)	0.000	82.390

DESIGN FLOW (m ³ /s)	0.056	0.050	0.043
CAPACITY (m ³ /s)	0.068	0.068	0.068
AT GRADE VELOCITY (m/s)	0.97	0.97	0.97
PIPE SIZE (mm) <td>3000</td> <td>3000</td> <td>3000</td>	3000	3000	3000
PIPE GRADE <td>1 in 200</td> <td>1 in 200</td> <td>1 in 200</td>	1 in 200	1 in 200	1 in 200
DATUM	207.0		
DEPTH TO INVERT	1.988	1.712	1.562
H.G.L.	213.623	213.912	214.01
INVERT LEVEL	213.66	213.677	213.782
FINISHED SURFACE	215.754	215.388	215.404
EXISTING SURFACE	215.726	215.885	215.915
PIPE CHAINAGE (Reach Length)	0.000	6.758	19.792

ISSUED FOR CONSTRUCTION

REV	DESCRIPTION	DATE	DRN.	APP.	REV	DESCRIPTION	DATE	DRN.	APP.
A	ISSUED FOR CONSTRUCTION	07.12.21	NT	RW					
P2	ISSUED FOR REVIEW	12.10.21	LS	RW					
P1	ISSUED FOR TENDER	01.09.21	LS	RW					

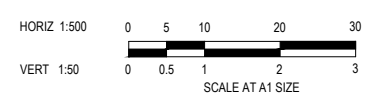

Designed S. GILBERT
 Date 23.08.21
 Drawn L. SUTHERLAND
 Approved R. WICKETT
 Date 7.10.2021
 PS Number PS 822978/NS3



Project Details
 DAVIS VINEYARD - STAGE 7
 AUST. INVESTMENT & DEVELOPMENT P/L
 CITY OF MELTON
 Drawing Title
 DRAINAGE LONGITUDINAL SECTIONS
 (SHEET 1 OF 2)

Sheet 16 of 17
 Scale
 1:500 H 1:50 V @ A1
 Project Ref 1600059
 Stage No 07
 Drawing No 400
 Rev A

NOTES:
 ALL STORMWATER DRAINS UP TO AND INCLUDING 750mm DIA. ARE TO BE CLASS 2 R.R.J. PIPES UNLESS NOTED OTHERWISE.

LEGEND	
	EXISTING SURFACE
	DESIGN SURFACE
	DRAINAGE PIPE/PIT
	EXISTING DRAINAGE PIPE/PIT
	HYDRAULIC GRADE LINE
	DENOTES 20mm CLASS 3 FCR BACKFILL

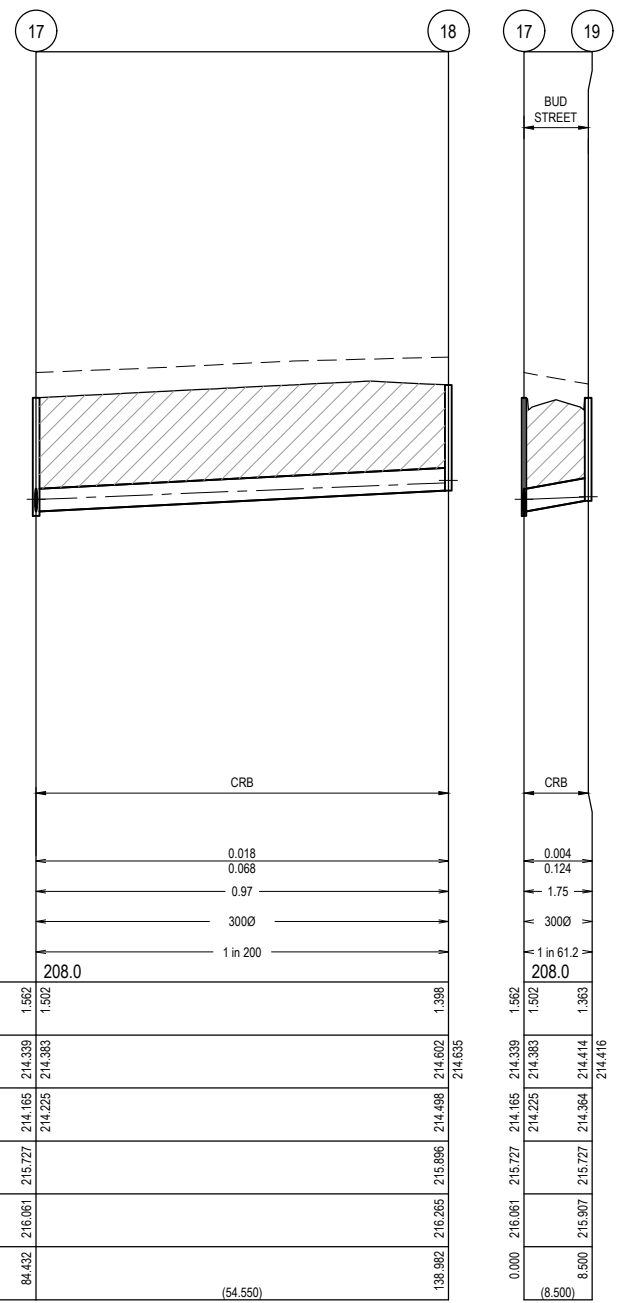

PIT NUMBER	PIT TYPE	INTERNAL DIMENSION		INLET		OUTLET		COVER LEVEL (m)	DEPTH (m)	STANDARD DRAWING	REMARKS
		WIDTH (mm)	LENGTH (mm)	DIAMETER (mm)	INVERT LEVEL (m)	DIAMETER (mm)	INVERT LEVEL (m)				
1	JUNCTION PIT	600 (T) 900 (B)	900 (T) 900 (B)	525	213.425			215.382	2.006	EDCM 607	CONSTRUCT PIT OVER EXISTING END PIPE
2	GRATED SIDE ENTRY PIT	600 (T) 900 (B)	900 (T) 900 (B)	525	213.686	525	213.626	215.819	2.193	EDCM 601 & 607	
3	GRATED SIDE ENTRY PIT	600 (T) 900 (B)	900 (T) 900 (B)	525	213.839	525	213.779	215.865	2.085	EDCM 601 & 607	
4	GRATED SIDE ENTRY PIT	600 (T) 900 (B)	900 (T) 900 (B)	450 300	214.031 214.181	525	213.956	215.607	1.651	EDCM 601 & 607	
5	END PIPE					450	214.227	215.834	1.607		CONNECT TO EXISTING END PIPE
6	GRATED SIDE ENTRY PIT	600	900			300	214.252	215.615	1.363	EDCM 601 & 605	
7	END PIPE			300	214.138			215.404	1.266		CONNECT TO EXISTING END PIPE
8	JUNCTION PIT	600	900			300	215.125	216.348	1.223	EDCM 605	CONSTRUCT JUNCTION PIT OVER EXISTING END PIPE
9	END PIPE			225	214.534			215.551	1.018		CONNECT TO EXISTING END PIPE
10	JUNCTION PIT	600	900			225	214.774	215.807	1.033	EDCM 605	
11	ENDWALL			225	213.919			215.296	1.377		CONSTRUCT TEMPORARY SAND BAG END WALL TO SUIT 225 DIA PIPE
12	JUNCTION PIT	600	900	225	214.242	225	214.182	215.345	1.163	EDCM 605	
13	JUNCTION PIT	600	900			225	214.502	215.529	1.027	EDCM 605	
14	ENDWALL			300	213.623			215.612	1.988		CONSTRUCT TEMPORARY SAND BAG END WALL TO SUIT 300 DIA PIPE
15	GRATED SIDE ENTRY PIT	600	900	300	213.737	300	213.677	215.389	1.712	EDCM 601 & 605	
16	GRATED SIDE ENTRY PIT	600	900	300	213.842	300	213.782	215.404	1.622	EDCM 601 & 605	
17	GRATED SIDE ENTRY PIT	600	900	300	214.225	300	214.165	215.727	1.562	EDCM 601 & 605	
18	GRATED SIDE ENTRY PIT	600	900	300	214.225	300	214.165	215.727	1.562	EDCM 601 & 605	
19	GRATED SIDE ENTRY PIT	600	900	300	214.225	300	214.165	215.727	1.562	EDCM 601 & 605	

DESIGN FLOW (m ³ /s)	0.018
CAPACITY (m ³ /s)	0.068
AT GRADE VELOCITY (m/s)	0.97
PIPE SIZE (mm)	3000
PIPE GRADE	1 in 200
DATUM	208.0
DEPTH TO INVERT	1.562
H.G.L.	214.339
INVERT LEVEL	214.165
FINISHED SURFACE	215.727
EXISTING SURFACE	216.061
PIPE CHAINAGE (Reach Length)	84.432

ISSUED FOR CONSTRUCTION

REV	DESCRIPTION	DATE	DRN.	APP.	REV	DESCRIPTION	DATE	DRN.	APP.
A	ISSUED FOR CONSTRUCTION	07.12.21	NT	RW					
P2	ISSUED FOR REVIEW	12.10.21	LS	RW					
P1	ISSUED FOR TENDER	01.09.21	LS	RW					

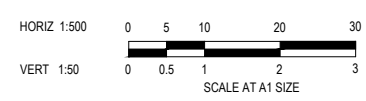

Designed Date: S. GILBERT 23.08.21
 Drawn: L. SUTHERLAND
 Approved Date: R. WICKETT 7.10.2021
 PS Number: PS 822978N/53



Project Details: DAVIS VINEYARD - STAGE 7 AUST. INVESTMENT & DEVELOPMENT P/L CITY OF MELTON
 Drawing Title: DRAINAGE LONGITUDINAL SECTIONS (SHEET 2 OF 2) AND PIT SCHEDULE

Sheet 17 of 17
 Scale: 1:500 H 1:50 V @ A1
 Project Ref: 1600059 Stage No: 07 Drawing No: 401 Rev: A